

GMQ King Extension Parts List

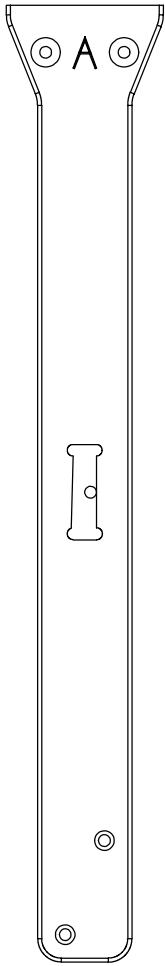

1-Middle
Leg

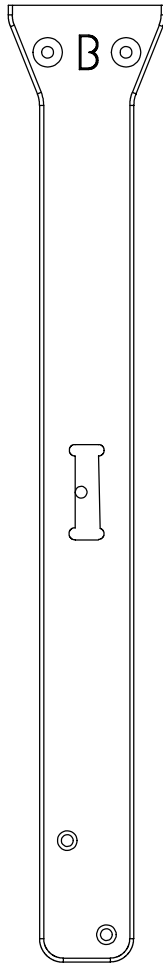

1-Opposing
Middle Leg

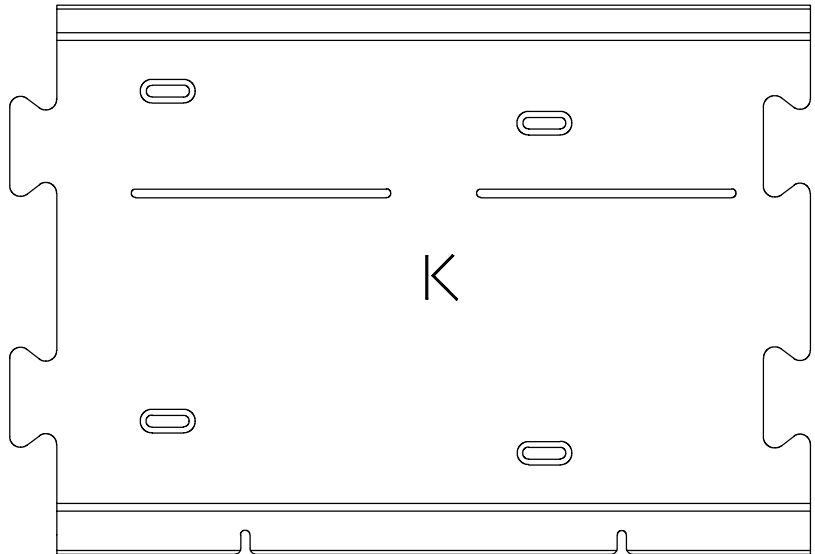

1-Table King Extension

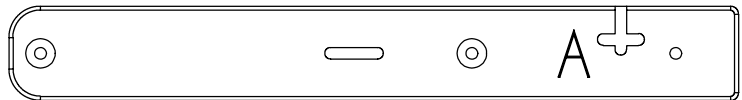

2-Brace Extension Part A

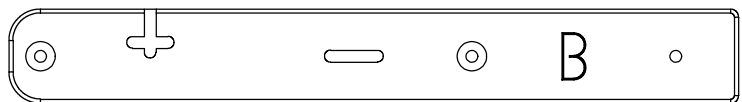

2-Brace Extension Part B

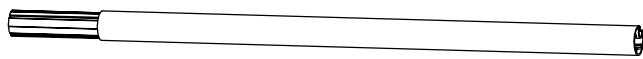

4-24" Rail & Coupler



4-24" Plastic Tubing - Pr-installed in Rail

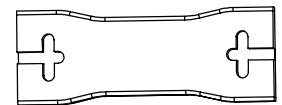

2-Middle Leg
Brace King Size

1-130" .25 Track

1-138" .25 Track

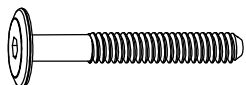

6-1/4 X 45mm
Connector Bolt

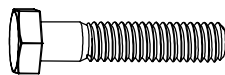

16-5/16 X 1 1/2
Hex Bolt

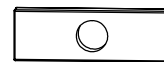

6-Threaded
Rectangle Nut

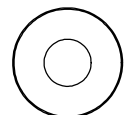

12-5/16
Washer

King Extension Assembly Kit

**You will use some hardware from your current assembly in addition to what is provided in this kit.

Step 1: Brace Extension Assembly

Parts Needed:

- 2 –Brace Extension Part A
- 2 –Brace Extension Part B
- 4 –5/16 x 1 1/2 hex bolt
- 4 –5/16 flatwasher

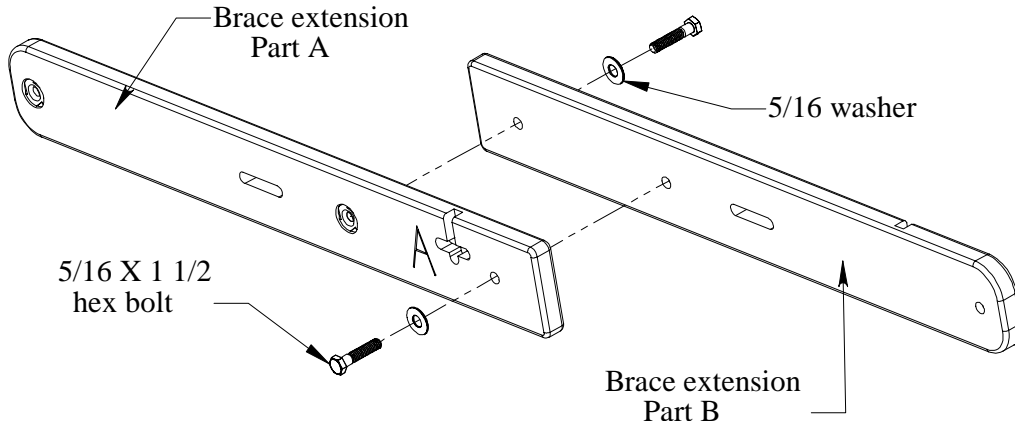
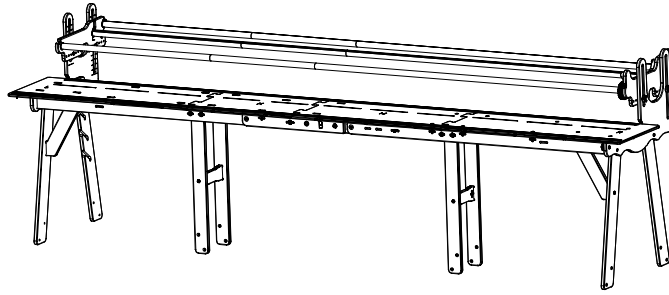

- Pair part “A” and “B” Brace Extension together as pictured. As you connect them, be sure the sides with the “A” and “B” are facing away from each other.
- Place the hex bolts through a washer and through the hole of the first part and into the hole with T-Nut in the second part, as pictured. . Repeat this process for both sets.

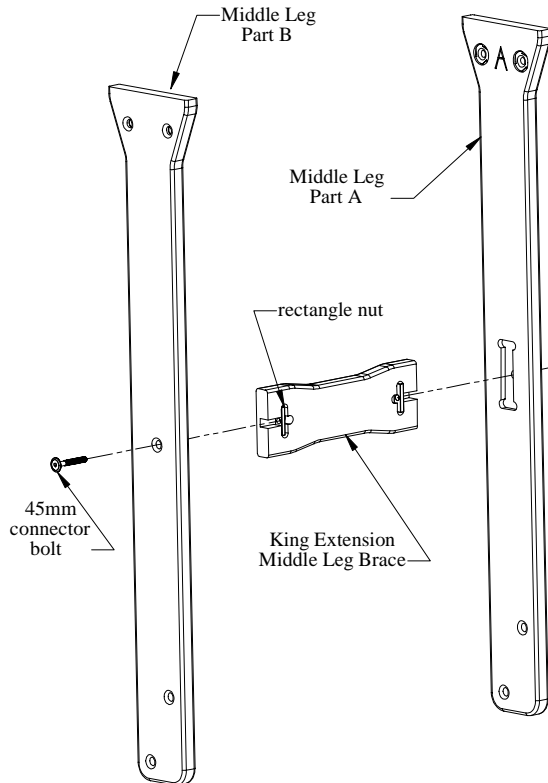

Step 2: King Leg Assembly

Parts Needed:

- 1 –Middle Leg
- 1 –Opposing Middle Leg
- 1 –King Extension Middle Leg Brace
- 2 –1/4 x 45mm Connector Bolts
- 2 –Rectangle Nuts

- Position the parts exactly as pictured for proper assembly (lettered sides facing in).
- Put the 45mm connector bolts through the holes in the legs and into the slot of the leg brace, threading it through the rectangle nut. Tighten the connector bolts completely.

Step 3: King Leg to Grace Machine Quilter Assembly

Parts Needed:

- 1 –King Size Middle Leg Brace
- 8 –5/16 x 1/2 Hex Bolt
- 8 –5/16 Flatwasher

➤ Disconnect the braces on the Grace Machine Quilter in the center. Remove the Middle Leg Assembly already installed on your frame, as well as the middle table top (if your machine was in queen size). The middle legs must then be disconnected from each other and you must insert the longer king size middle leg brace. Reconnect the leg assembly.

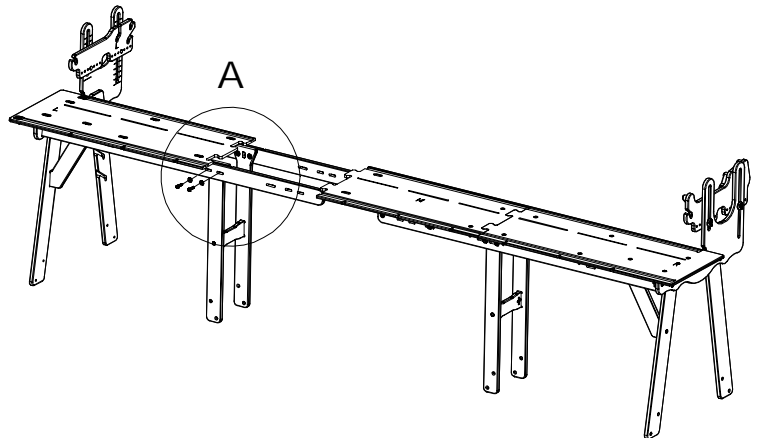

➤ Now install both king size middle leg assemblies to the braces. These will install into the slots located almost directly under the edges or seams of the Left and Right table tops

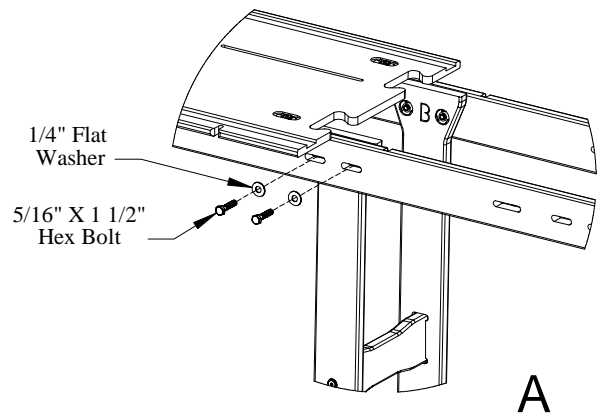

➤ See section one, Step 4 of the Grace Machine Quilter assembly instructions for details on re-attaching the leg assembly to the braces, ignoring their position on the braces in the pictures. Substitute the 2" hex bolts used in the old configuration for 1 1/2" hex bolts provided.

➤ NOTE! Do not completely tighten 1 1/2 bolts at this time. Leave loose to allow for final frame adjustments after the rails are installed!

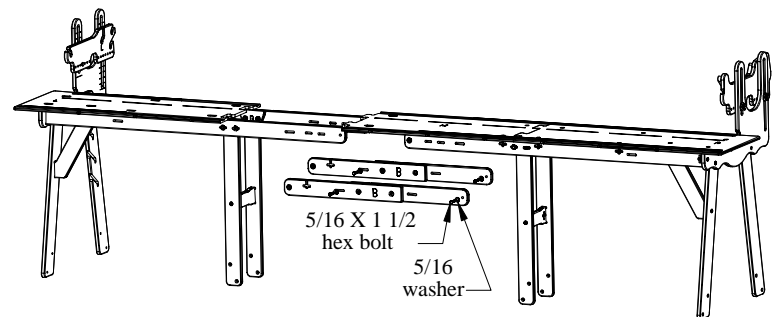

Step 4: Brace Extension to Grace Machine Quilter

Parts Needed:

- 2 –Brace Assembly
- 8 –5/16 x 1 1/2 Hex Bolt
- 8 –5/16 x Flatwasher

➤ Connect the two King extension brace assemblies to the ends of the Grace Machine Quilter braces as pictured.

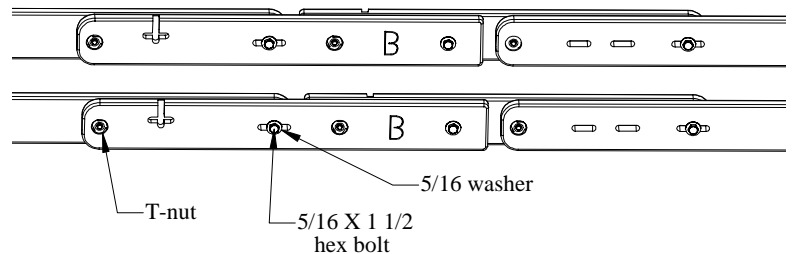

➤ Make sure the T-Nuts are facing outside and away from the frame, and that bolts go into and through the slots, and then into the T-Nuts from behind, as before.

NOTE! Do not completely tighten 1 ½ bolts at this time. Leave loose to allow for final frame adjustments after the rails are installed!

Step 5: Table Top and Track Assembly

Parts Needed

- 1 – 130” .25 Track
- 1 – 138” .25 Track
- 1 –Table King Extension
- 6 –1/4 x 45mm Connector Bolt
- 6 –Rectangle Nut

- With your braces connected, you are ready to put your king size table top into place. Do so with the “K” right side up facing the same direction as the “M” on the adjacent table top.
- Secure the king size table top using four ¼ x 45mm connector bolts and rectangle nuts. Secure the middle table top using two ¼ x 45 mm connector bolts and rectangle nuts.
- NOTE! Do not completely tighten 1 ½ bolts at this time. Leave loose to allow for final frame adjustments after the rails are installed!
- Place the 130” and 138” tracking into place as pictured.

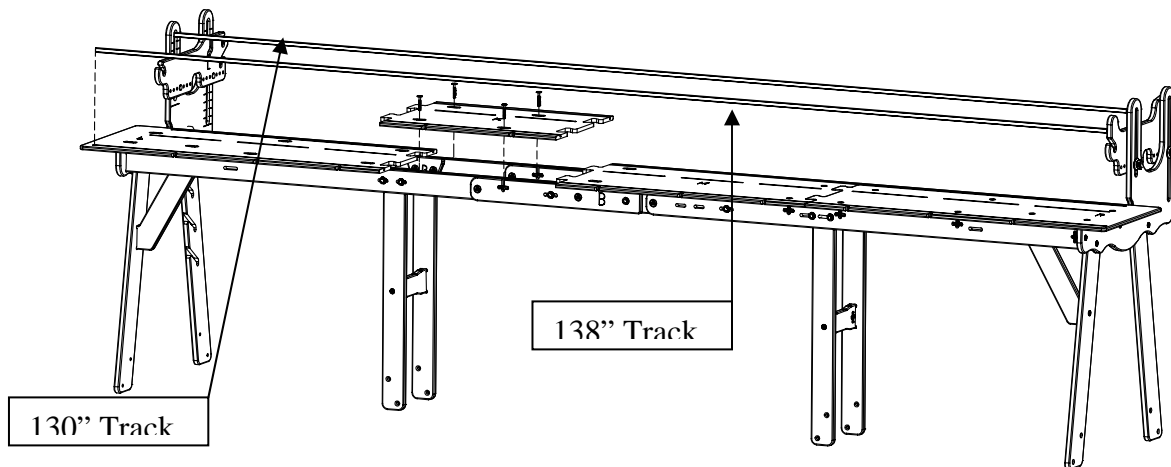

Step 6: King Rail Assembly

Parts Needed: 4 – 24” Rail Extensions
4 – 24” Dowels

- With each rail, place the 24” rail with coupler in between the 70” rail and 34” rail as pictured.
- Put your rails in place on the frame, noting any gaps between the rail ends and Pole Mount Ends.

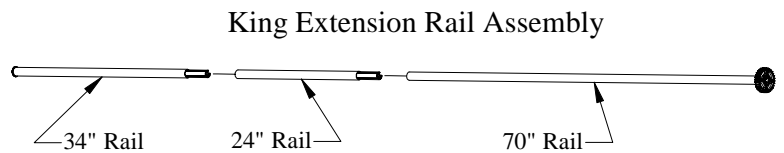

- You will now push in on the frame from both sides, being sure to eliminate any space between all three the rail ends and Pole Mount Ends.
- Having done this adjustment, you are now ready to tighten all bolts and the braces and table tops.

YOU HAVE NOW COMPLETED YOUR KING SIZE EXTENSION ASSEMBLY!