

Q-Zone *Hoop-Frame* **PRO**

Assembly Instructions

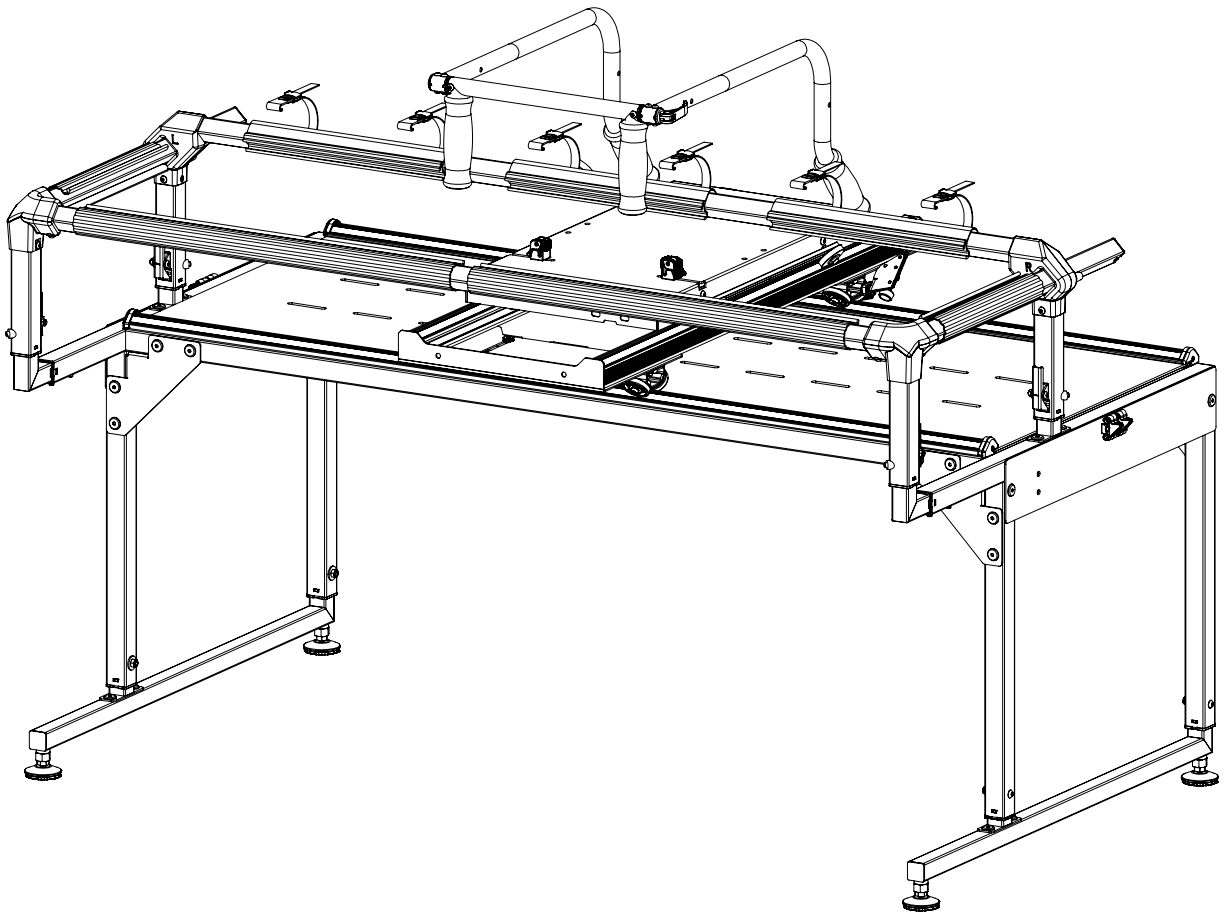

Copyright October 19, 2020
Grace Company
(Reproduction Prohibited)
Version 1.1
US Patent 9476151

MADE BY
Grace

Table of Contents

Table of Contents	i
Parts List	
Box 1	ii
Box 2	iii
Box 3	iv
Assembly Instructions	
Step 1: Right Leg Setup	1
Step 2: Left Leg Setup	3
Step 3: Frame Cross Support Installation	5
Step 4: Front Long Rail Installation	6
Step 5: Carriage Assembly	7
Step 6: Carriage Installation	8
Step 7: Back Long Rail Installation	9
Step 8: Basic Setup	11
Step 9: Fabric Setup	12
Step 10: Fabric Installation	13
Maintenance and Accessories	
Care and Use	16
Making Leader Cloths	17
Top Plate Assembly - Optional Accessory	18

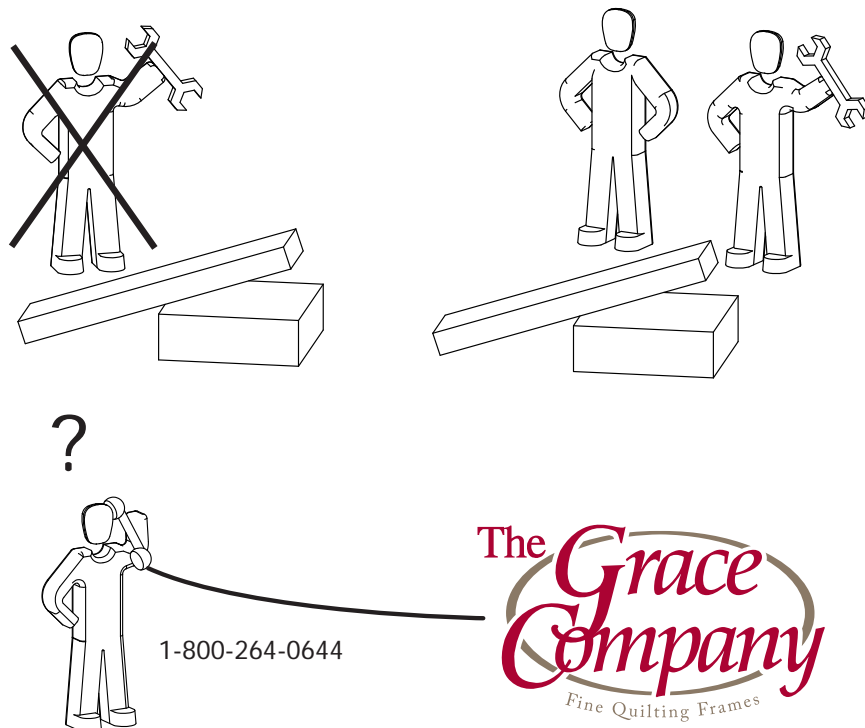

Part List

Box 1

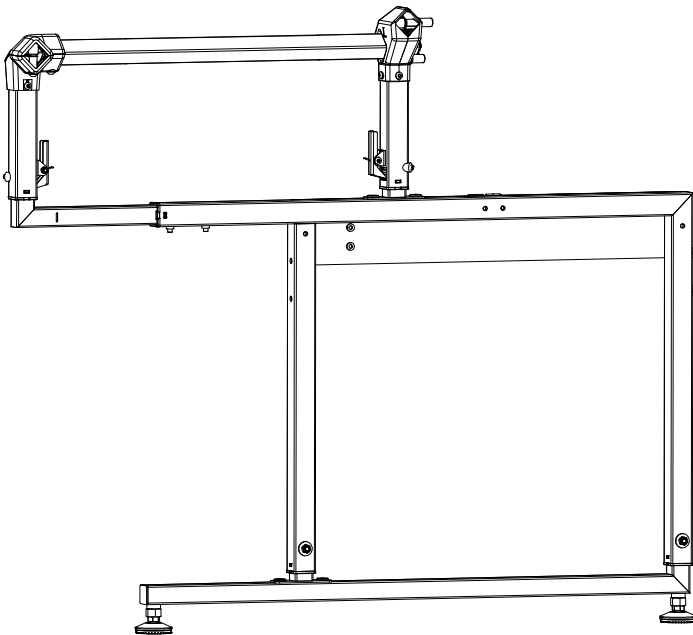

Left Leg Assembly (1)

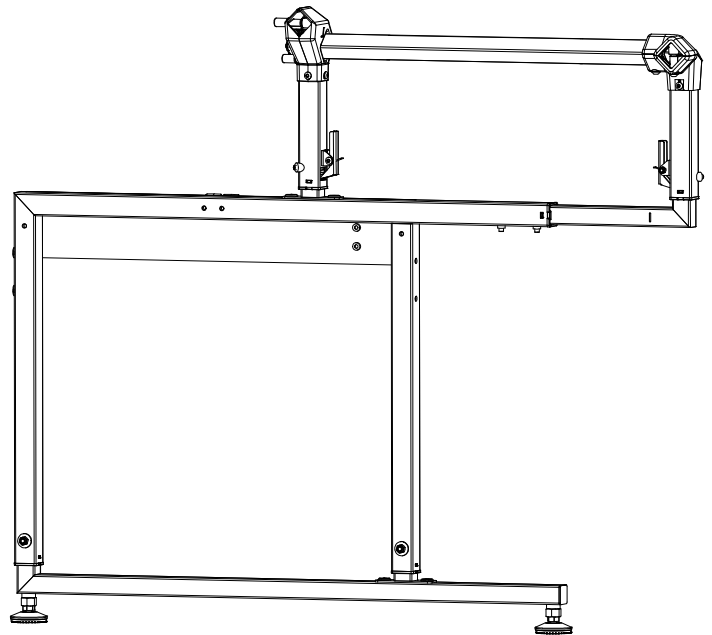

Right Leg Assembly (1)

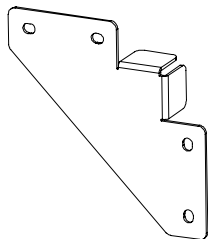

Corner Brace (4)
(QZF-04-12031)

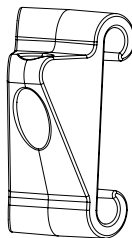

Bungee Mount (4)
(SVP-05-13306)

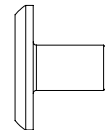

M6 x 10mm Connector
Bolt (16)
(HDW-03-10953)

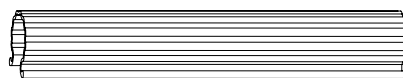

Side Fabric Clip (2)
(QZF-05-12024)

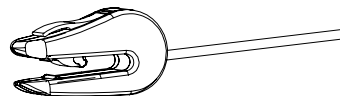

Bungee Clamp
Assembly (4)
(ACC-01-10261)

Parts List

Box 1 - Continued

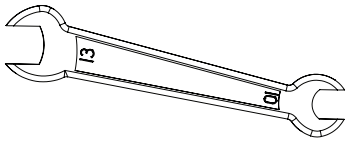

10mm & 13mm Box
End Wrench (1)
(HDW-03-10743)

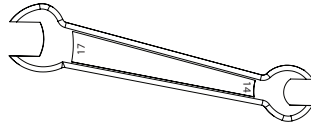

14mm & 17mm Box
End Wrench (1)
(HDW-03-12068)



3mm Allen Wrench (1)
(HDW-03-10166)



4mm Allen Wrench (1)
(HDW-03-10167)

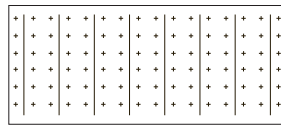

Hoop Frame Leader
Cloth Set (1)
(ACC-01-13370)

Box 2



Front Fabric Clip (2)
(QZF-05-12025)



Fabric Clip (3)
(QZF-05-12023)

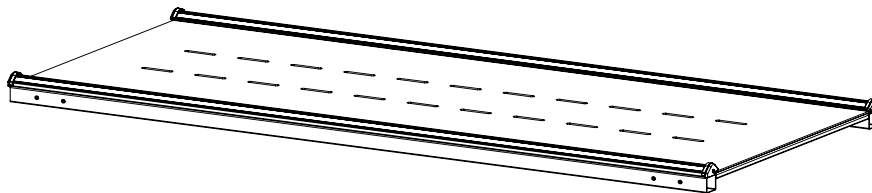
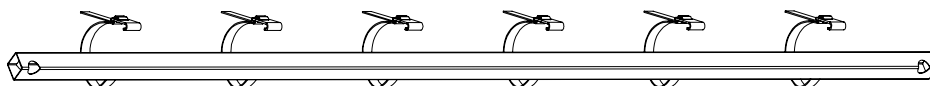

Table Assembly (1)
(SVP-09-13363)



Back Long Rail (1) (QZF-09-13040)



Front Long Rail (1) (QZF-09-12030)

Parts List

Box 3

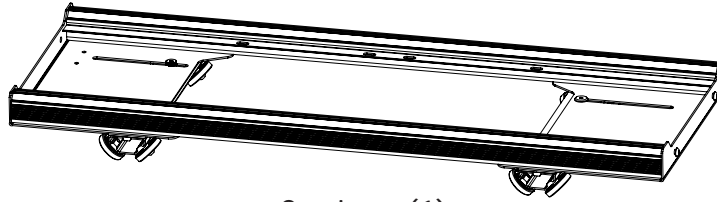

Carriage (1)
(CNT-09-11866)

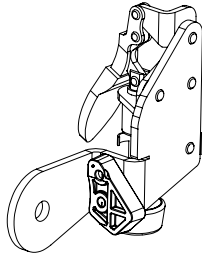

Channel Lock (2)
(ACC-09-13057)

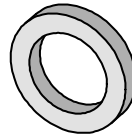

Channel Lock
Washer (2)
(CNT-04-11580)

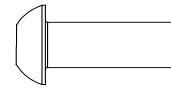

M6 x 20mm
SBHCS (2)
(HDW-03-10088)

Assembly

Step 1 – Right Leg Setup

Parts Needed:

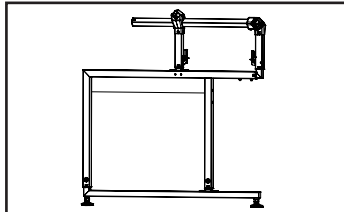

**Right Leg
Assembly (1)**

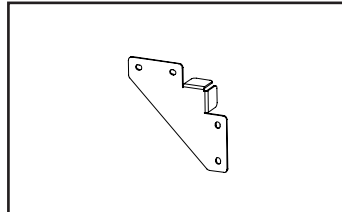

Corner Brace (2)

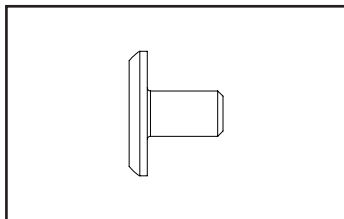

**M6 x 10mm
Connector Bolt (4)**

Tools Needed:

3mm Allen Wrench

4mm Allen Wrench

10mm & 13mm Box End Wrench

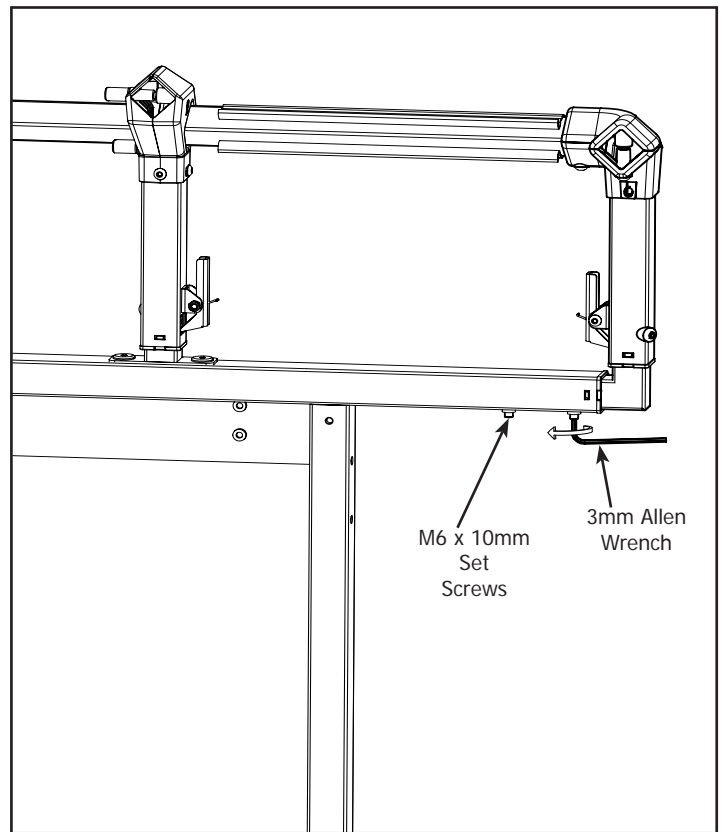

1-1 Loosen the (2) M6 x 10 Set Screws.

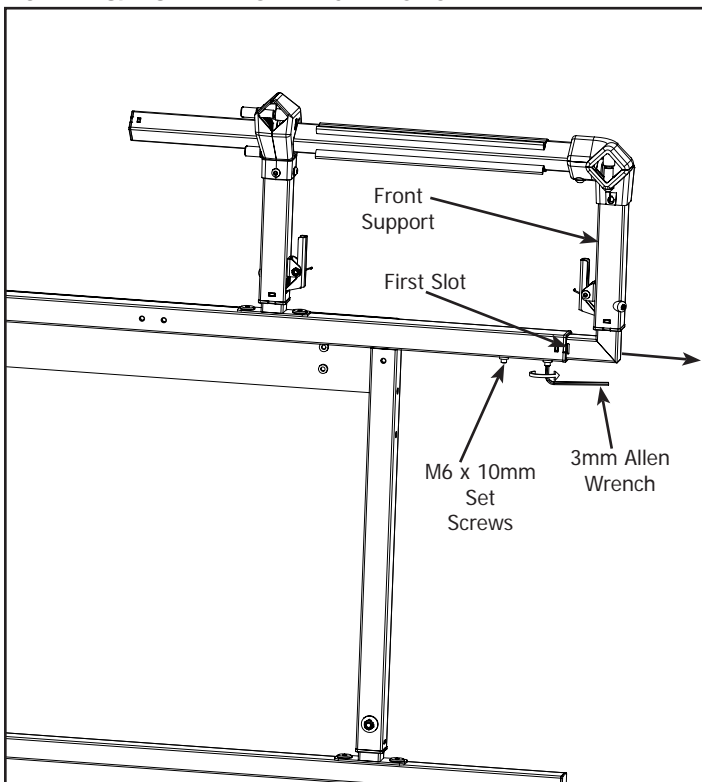

1-2 Extend the Front Support forward until the first slot is visible in tube.

Tighten the (2) M6 x 10mm Set Screws.

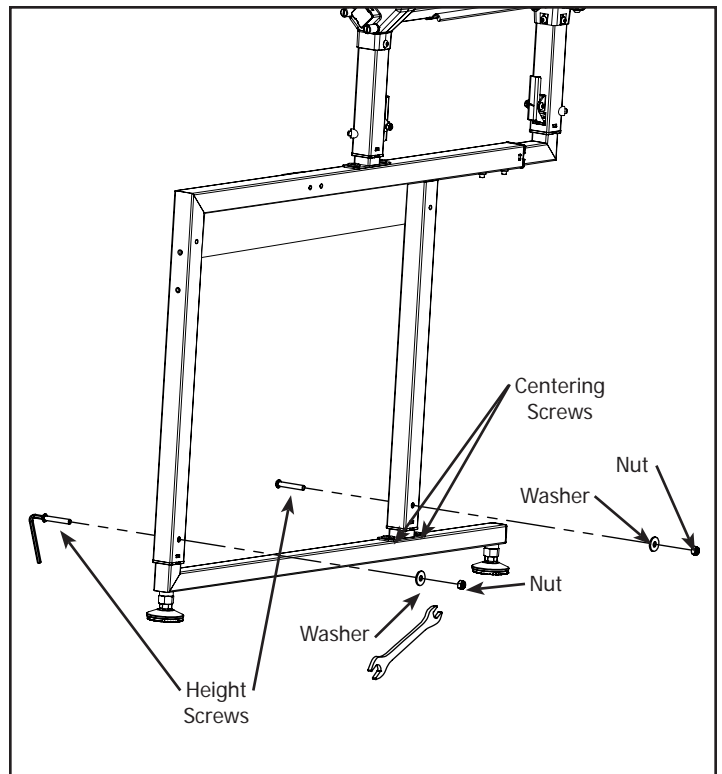

1-3 Remove height screws and loosen centering screws.

Assembly

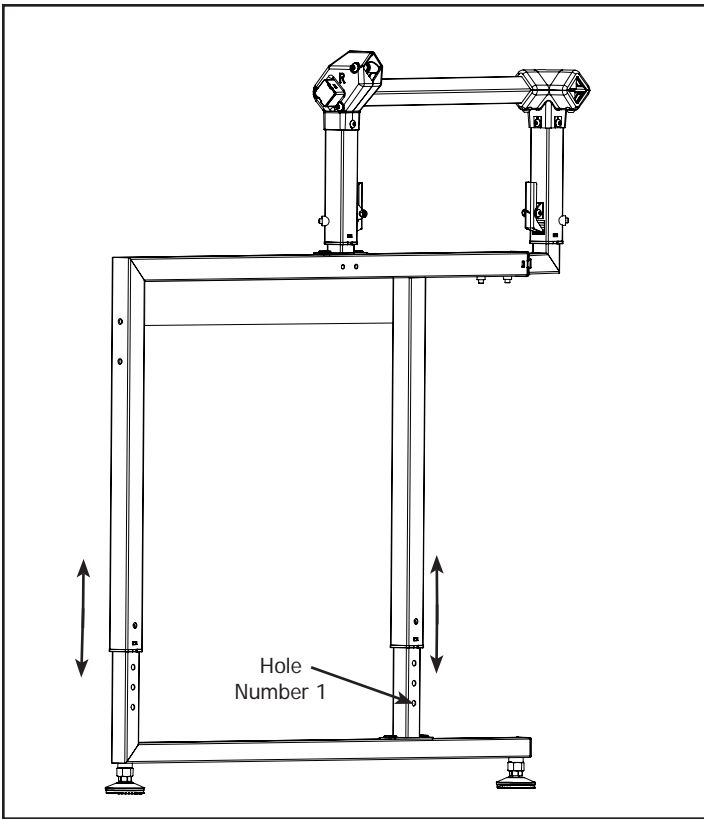

Hole Number	Floor to Top of Fabric
1	31 Inches
2	32 Inches
3	33 Inches
4	34 Inches
5	35 Inches
6	36 Inches
7	37 Inches
8	38 Inches
9	39 Inches
10	40 Inches

1-4 Adjust table height by sliding legs up or down using the chart to the right for your desired height.

Note: Height will vary slightly after adjusting Leveling Feet in Step 10-1.

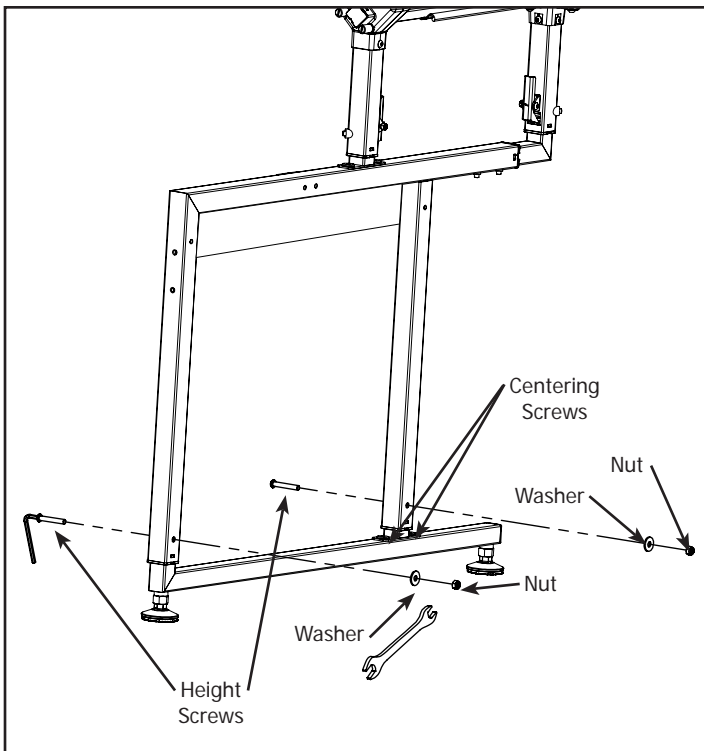

1-5 Replace each height screw and tighten each centering screw.

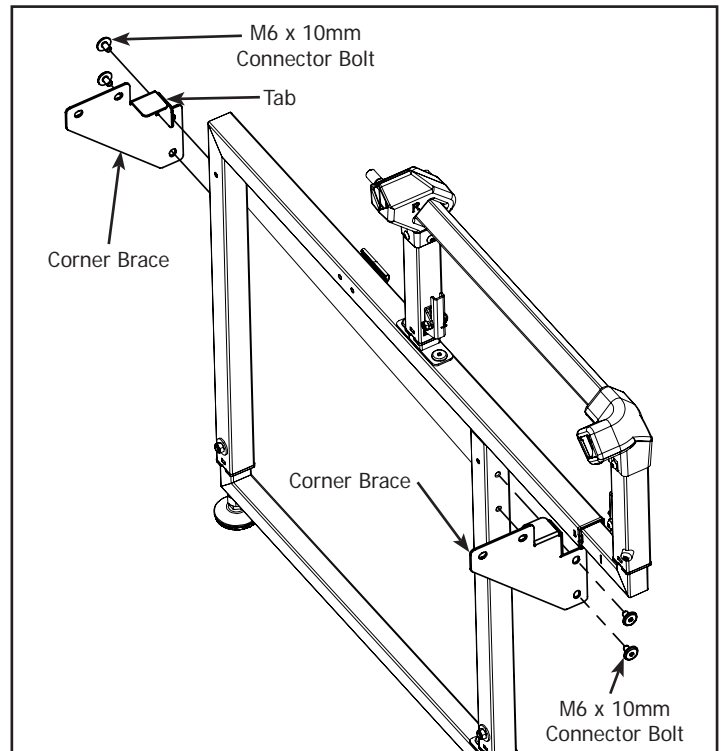

1-6 Install (2) Corner Braces with the tabs toward the inside of the leg using (4) M6 x 10mm Connector Bolts.

Note: Leave M6 x 10mm Connector Bolts loose so that you may align the adjoining parts.

Assembly

Step 2 – Left Leg Setup

Parts Needed:

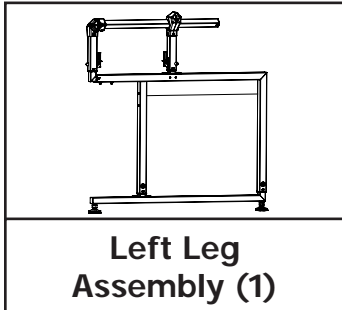

Left Leg Assembly (1)

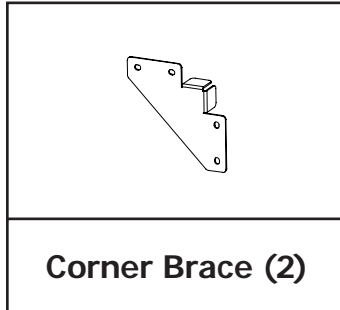

Corner Brace (2)

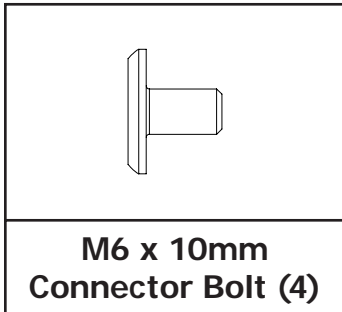

M6 x 10mm Connector Bolt (4)

Tools Needed:

3mm Allen Wrench

4mm Allen Wrench

10mm & 13mm Box End Wrench

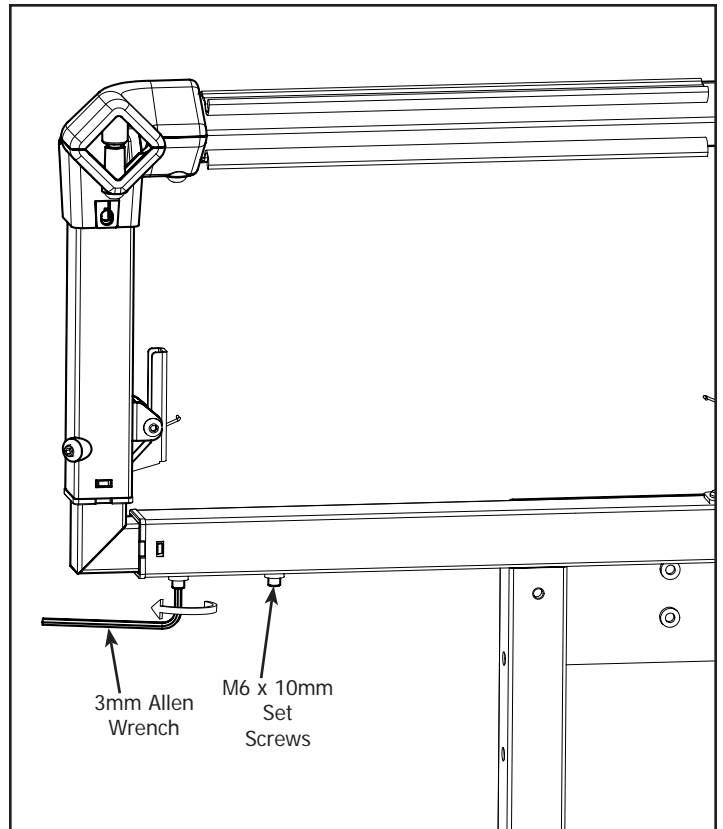

2-1 Loosen the (2) M6 x 10 Set Screws.

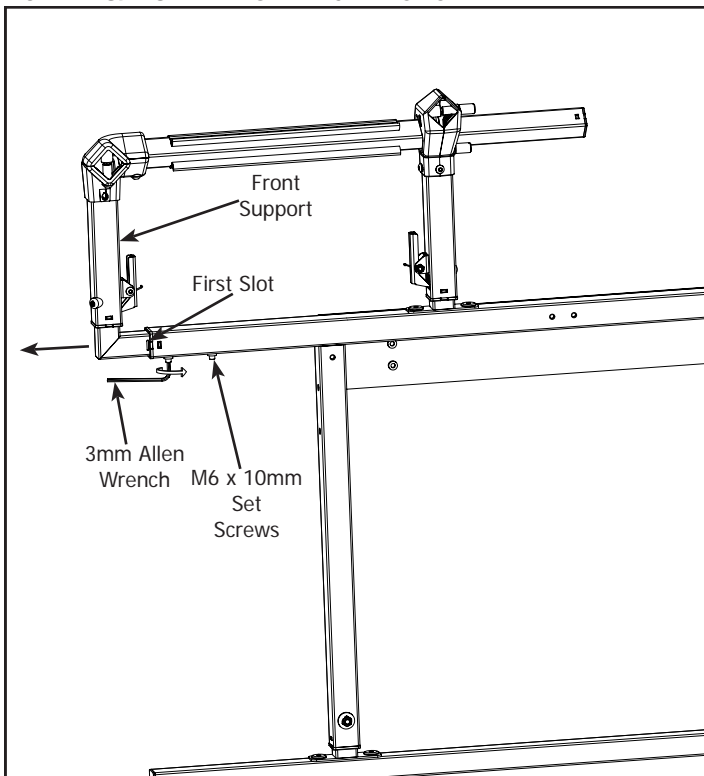

2-2 Extend the Front Support forward until the first slot is visible in tube.

Tighten the (2) M6 x 10mm Set Screws.

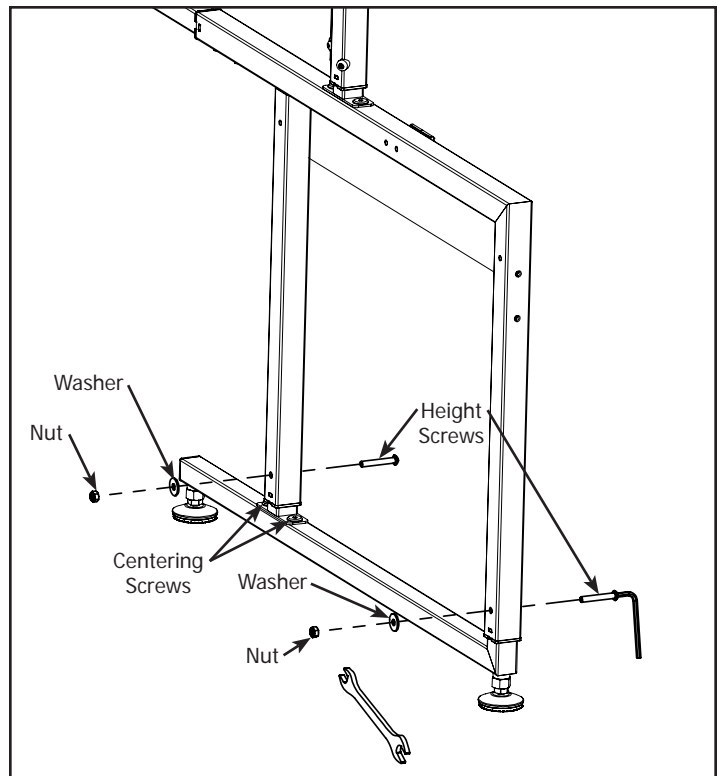

2-3 Remove height screws and loosen centering screws.

Assembly

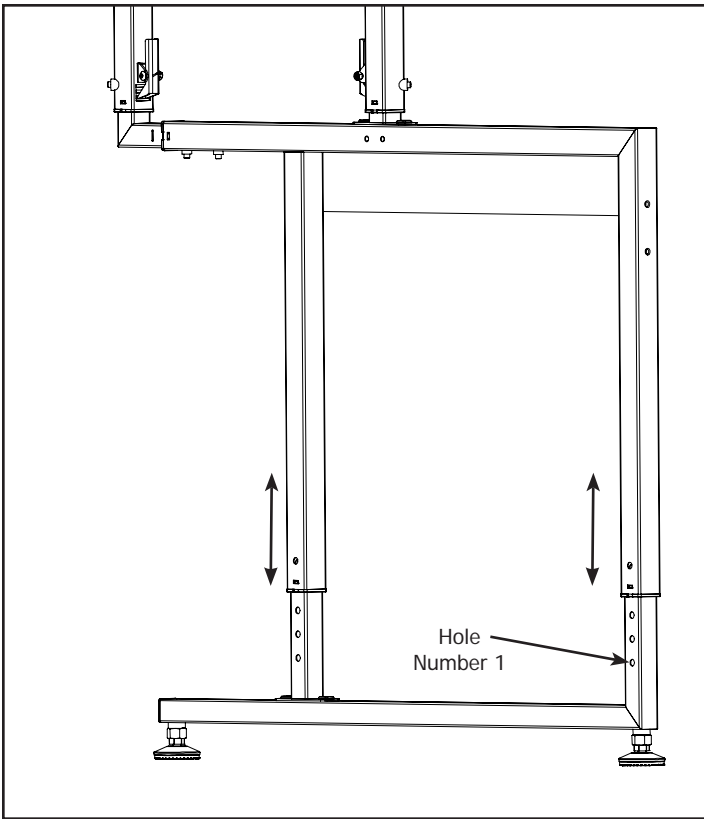

Hole Number	Floor to Top of Fabric
1	31 Inches
2	32 Inches
3	33 Inches
4	34 Inches
5	35 Inches
6	36 Inches
7	37 Inches
8	38 Inches
9	39 Inches
10	40 Inches

2-4 Adjust table height by sliding legs up or down using the chart to the right for your desired height.

Note: Height will vary slightly after adjusting Leveling Feet in Step 10-1.

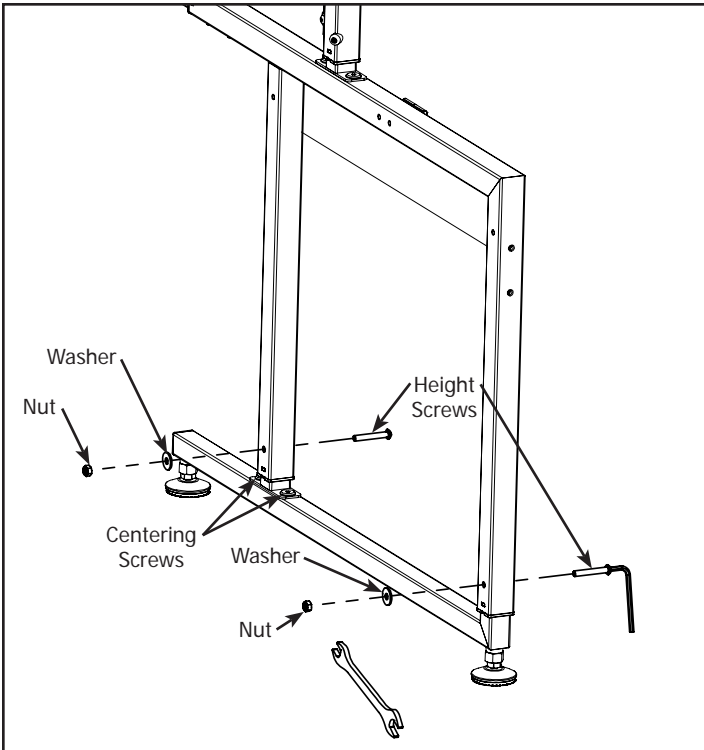

2-5 Replace each height screw and tighten each centering screw.

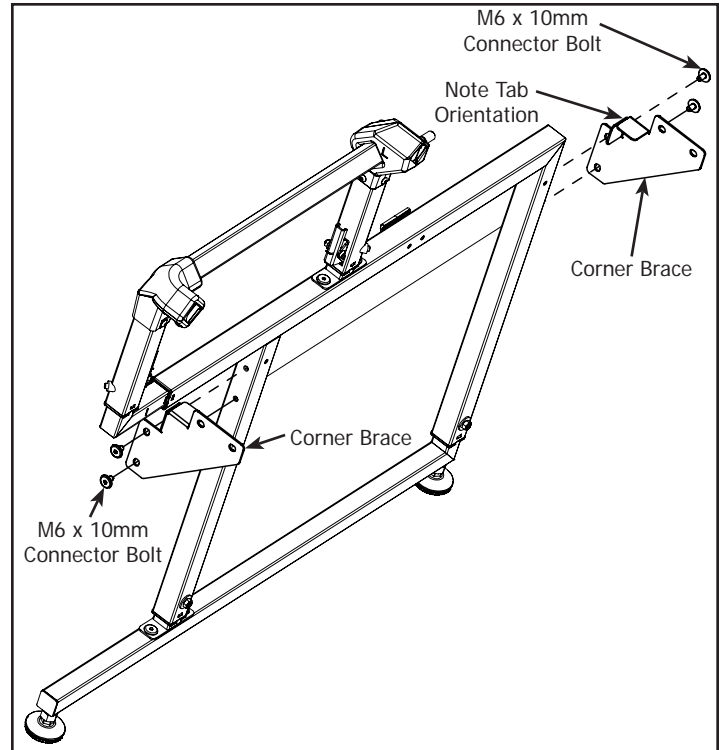

2-6 Install (2) Corner Braces with the tabs toward the inside of the leg using (4) M6 x 10mm Connector Bolts.

Note: Leave M6 x 10mm Connector Bolts loose so that you may align the adjoining parts.

Assembly

Step 3 – Frame Cross Support Installation

Parts Needed:

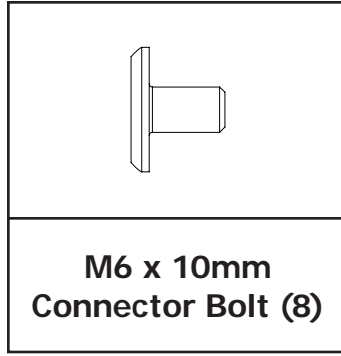
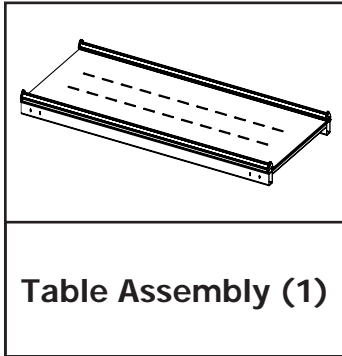

Tools Needed:

4mm Allen Wrench

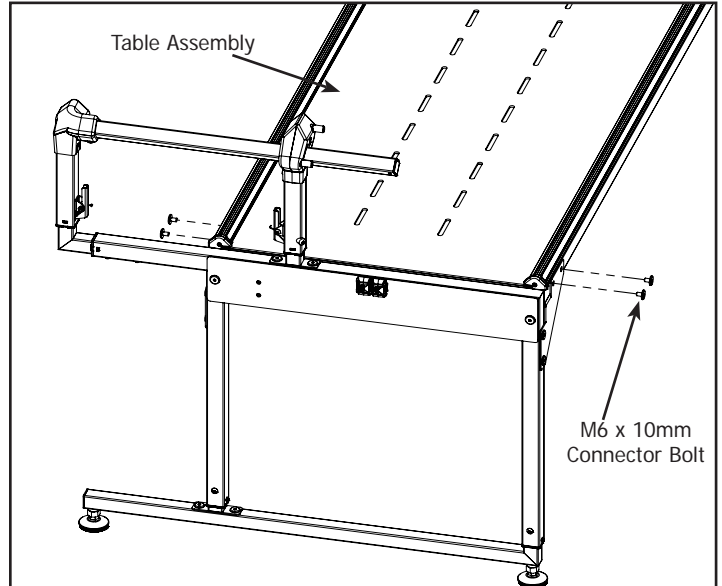

3-1 Install the Table Assembly to the Right Leg using (4) M6 x 10mm Connector Bolts by angling the Table Assembly toward the ground.

Note: Leave bolts loose so that you may align the adjoining parts.

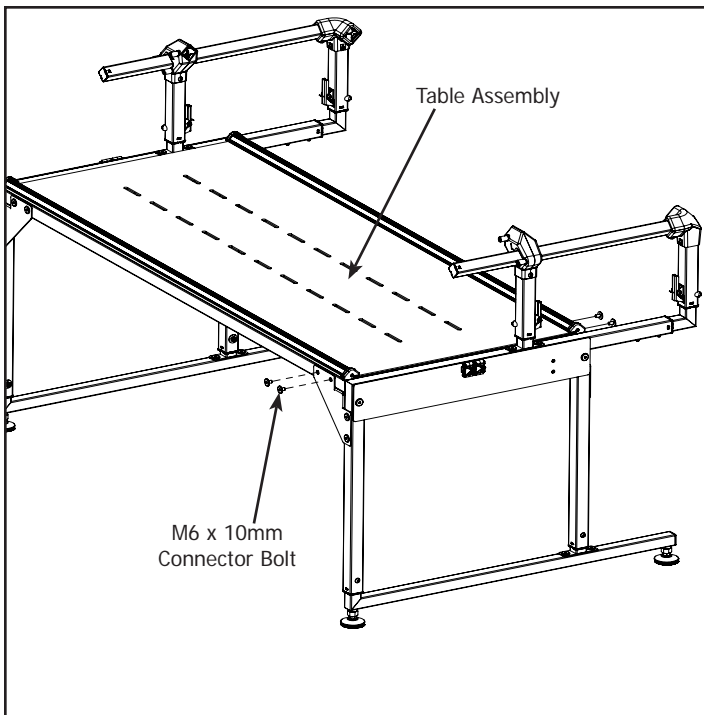

3-2 Install the Table Assembly to the Left Leg using (4) M6 x 10mm Connector Bolts by resting the Table Assembly on the Brace Tabs.

Note: Leave bolts loose so that you may align the adjoining parts.

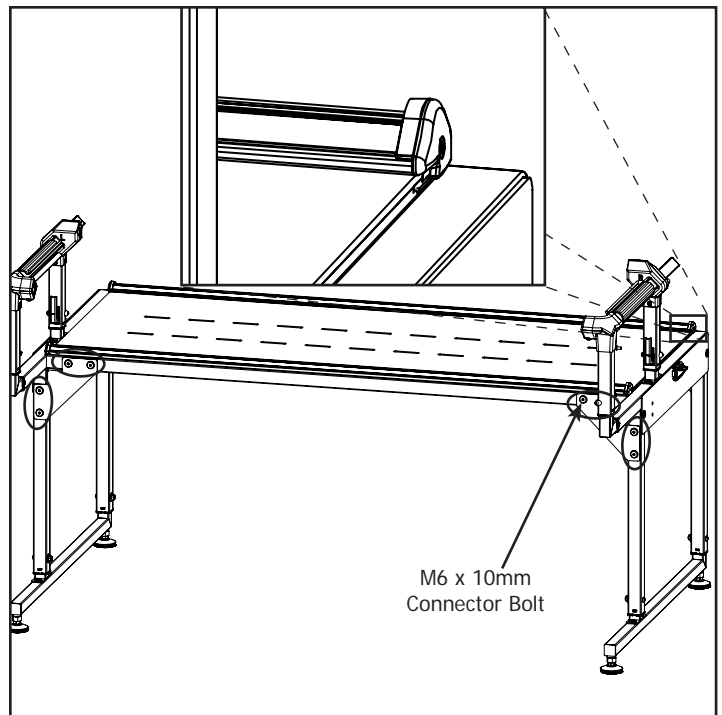

3-3 Press the Right and Left Legs tight against the Table Assembly and tighten the (16) M6 x 10mm Connector Bolts.

Note: Make sure that the Table Assembly is flush with the top of both Right and Left Legs.

Assembly

Step 4 - Front Long Rail Installation

Parts Needed:

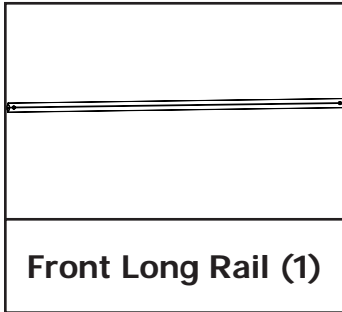

Tools Needed:

4mm Allen Wrench

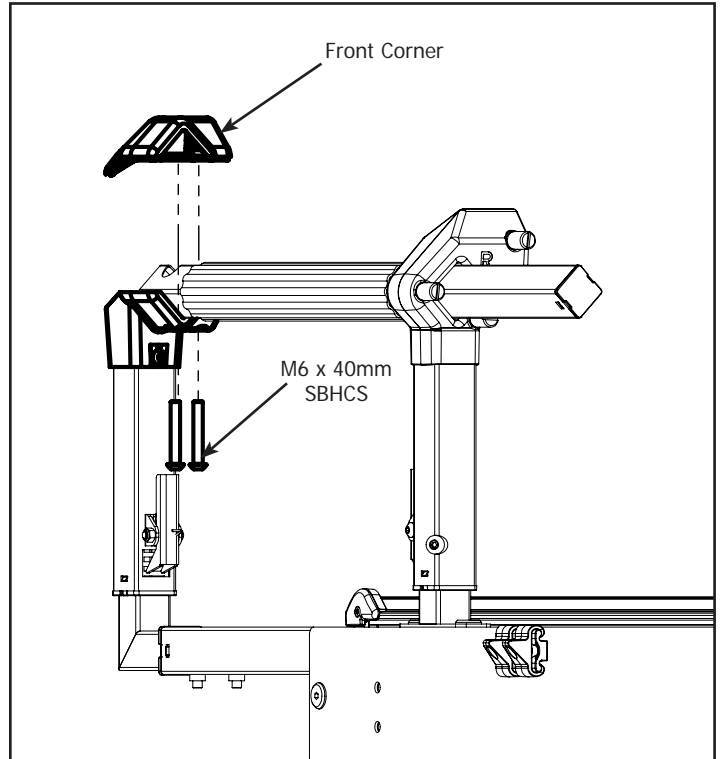

4-1 Remove the (2) M6 x 40mm SBHCS from the Right Front Corner.

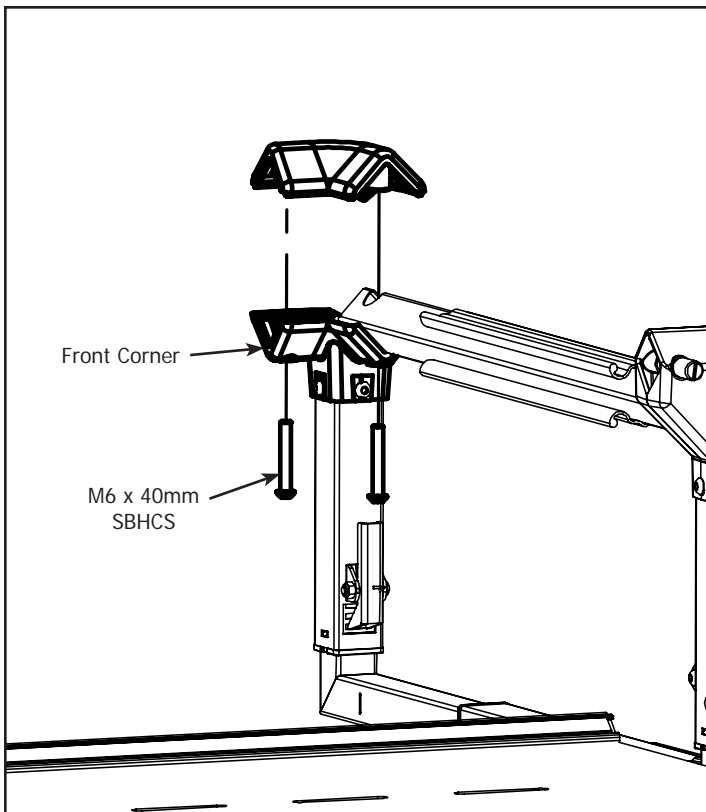

4-2 Remove the (2) M6 x 40mm SBHCS from the Left Front Corner.

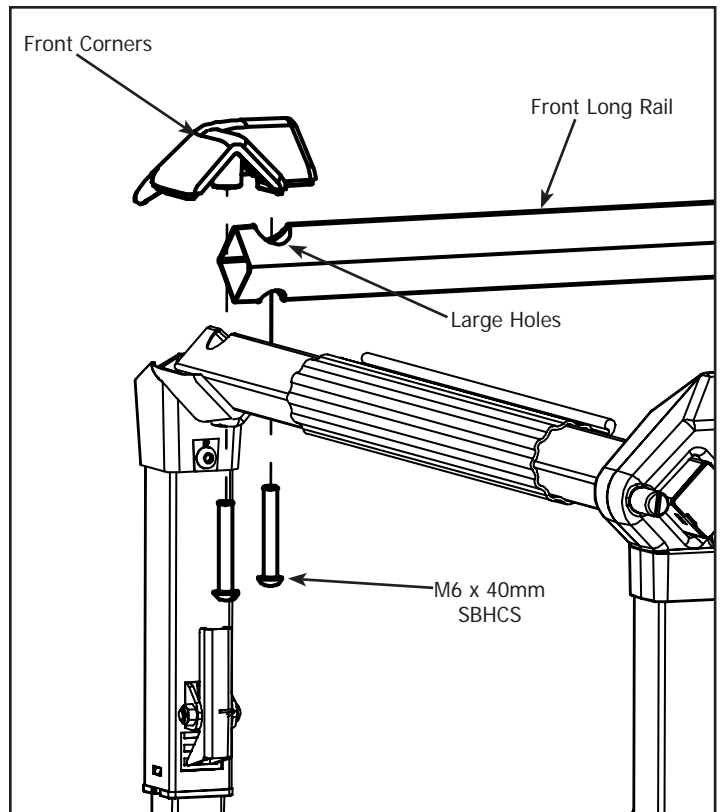

4-3 Install the Front Long Rail with the larger holes up. Reinstall the Front Corners using the (4) M6 x 40mm SBHCS removed in previous steps.

Assembly

Step 5 - Carriage Assembly

Parts Needed:

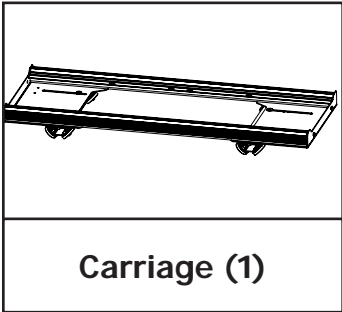

Carriage (1)

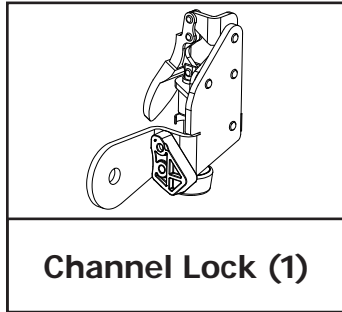

Channel Lock (1)

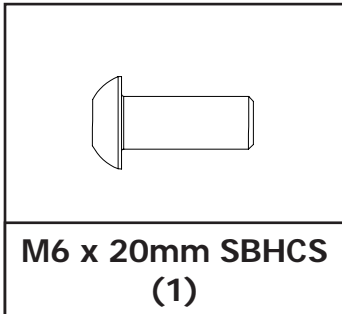

M6 x 20mm SBHCS
(1)

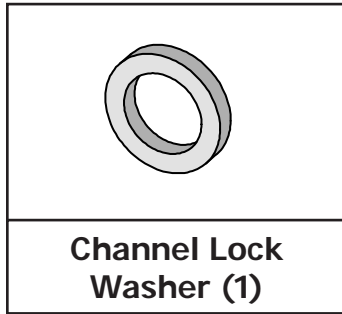

Channel Lock
Washer (1)

Tools Needed:

4mm Allen Wrench

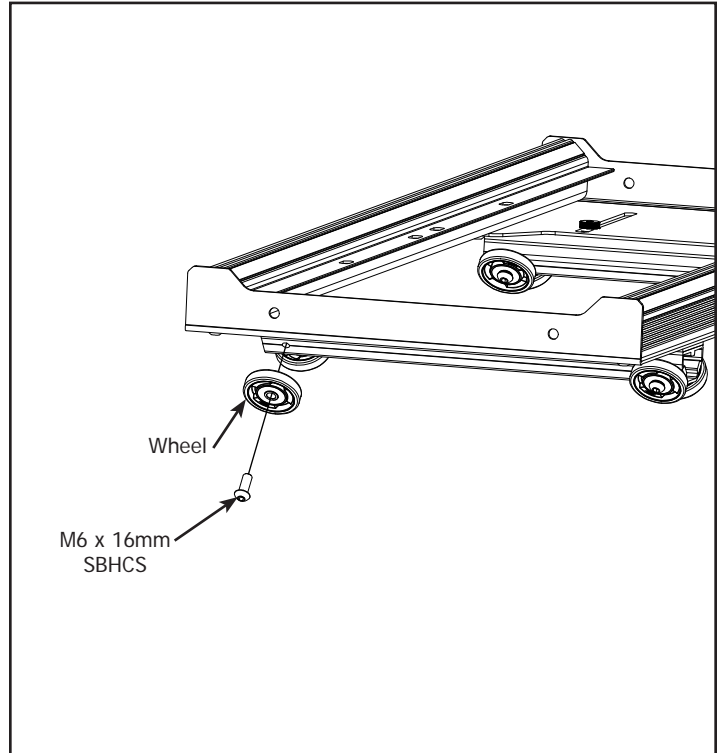

5-1 Remove the right rear M6 x 16mm SBHCS and Wheel from the Carriage.

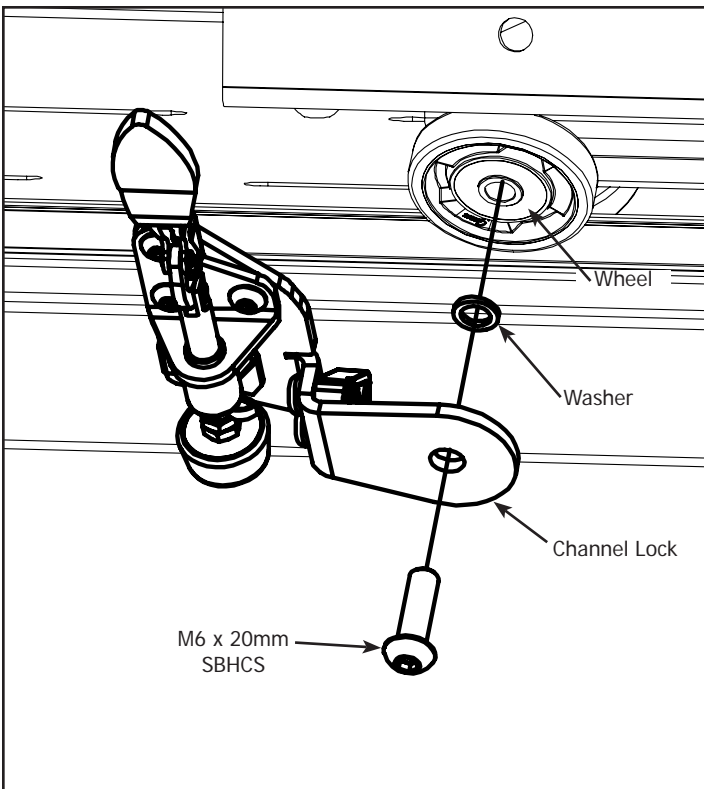

5-2 Install the Channel Lock with (1) M6 x 20mm SBHCS making sure the washer is between the Wheel and the Channel Lock.

Note: See step 10 for Channel Lock adjustments.

Assembly

Step 6 - Carriage Installation

Tools Needed:

4mm Allen Wrench

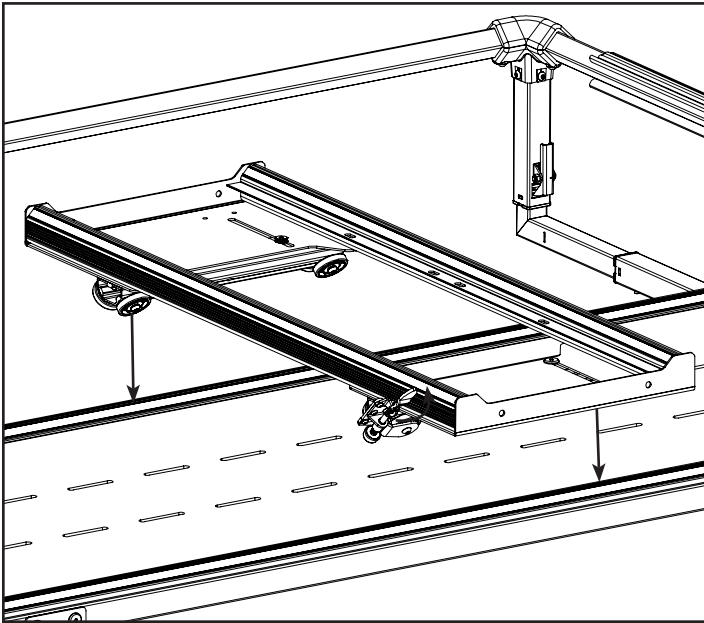

6-1 Place the Carriage onto the Track.

Note: Make sure the Channel Lock is in the open position.

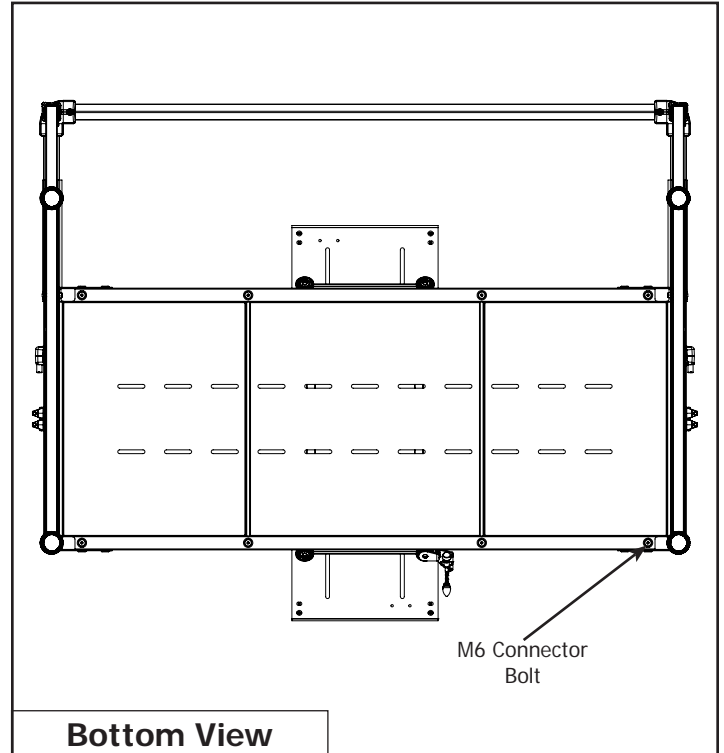

6-2 Loosen the (4) M6 Connector Bolts for the Back Track Assembly.

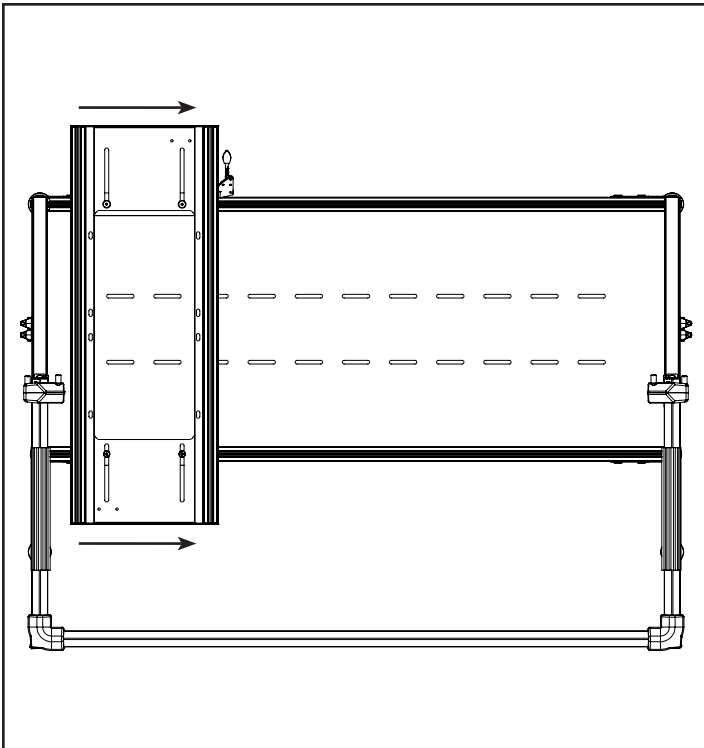

6-3 Slowly move the Carriage from one end of the Track to the other, tightening each of the (4) M6 Connector Bolts as you go.

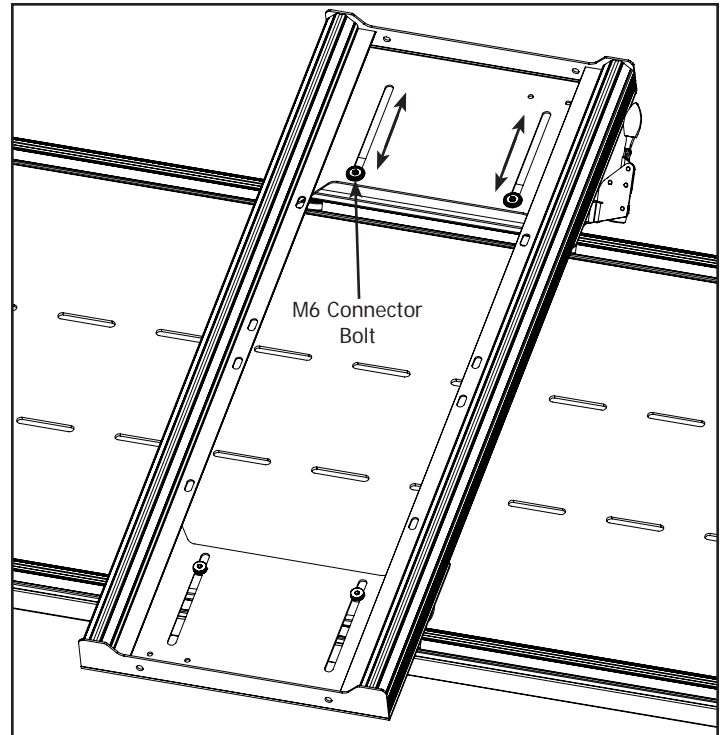

6-4 To adjust the carriage wheels, loosen the (2) M6 Connector Bolts and adjust the Carriage to fit to the track. Roll the carriage from side to side as you tighten each M6 Connector Bolt. Make sure the carriage rolls smoothly.

Assembly

Step 7 - Back Long Rail Installation

Parts Needed:

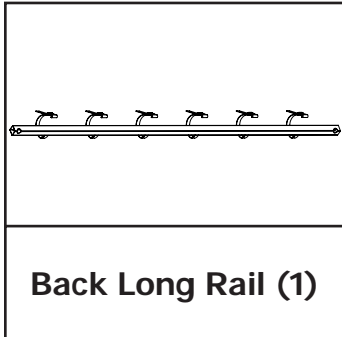

Tools Needed:

4mm Allen Wrench

STOP: Follow quilting machine manual for instructions on preparing and installing the machine before continuing. If using a top plate and home sewing machine, see page 18.

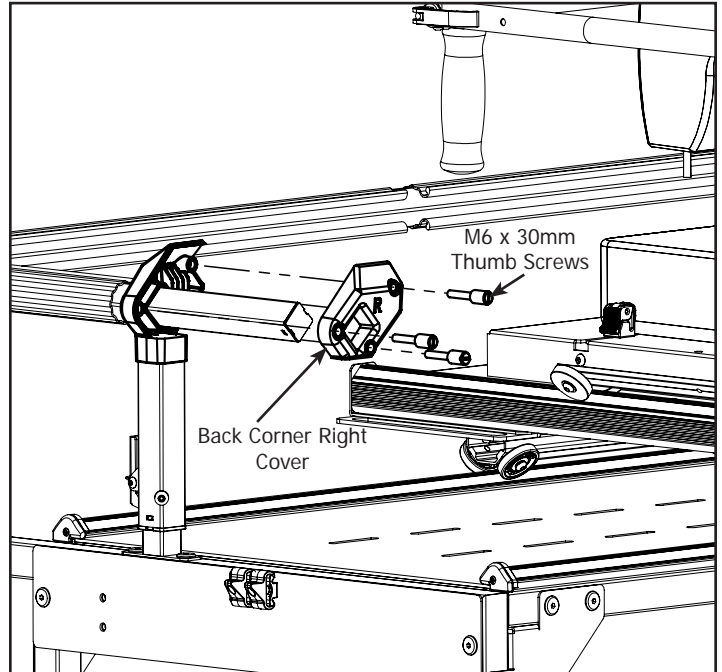

7-1 Remove the (6) M6 x 30mm Thumb Screws from the right and left Back Corner Covers and remove the Back Corner Covers.

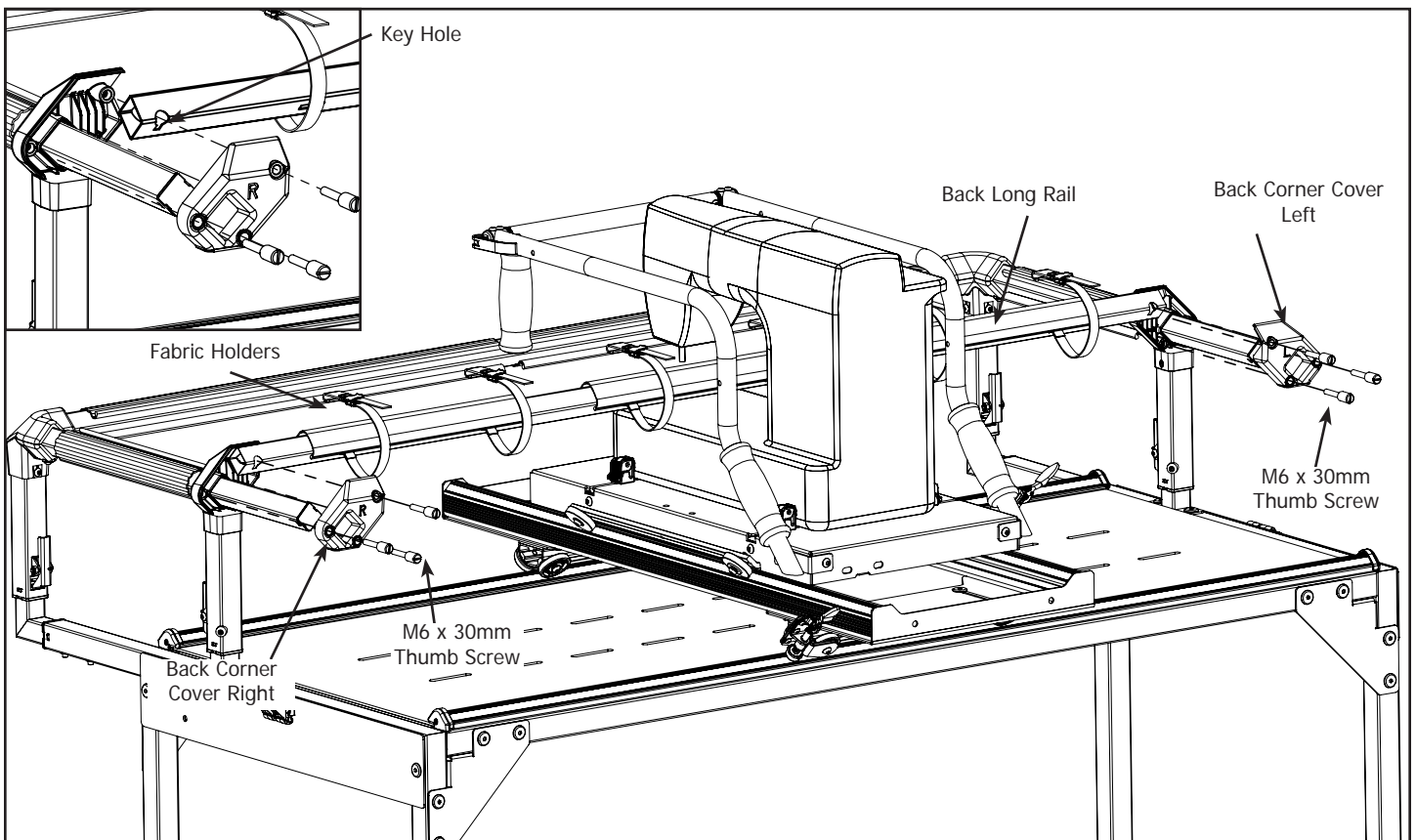

7-2 Install the Back Long Rail through the throat of your machine and reinstall the Back Corner Right and Left Covers using (6) M6 x 30mm Thumb Screws removed in the previous step.

Note: The Key Hole and Fabric Holder on Back Long Rail needs to be oriented as shown above.

Setup

Step 8 - Basic Setup

Parts Needed:

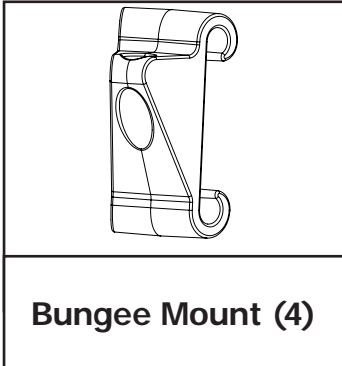

Tools Needed:

3mm Allen Wrench
10mm/13mm Box End Wrench
14mm/17mm Box End Wrench

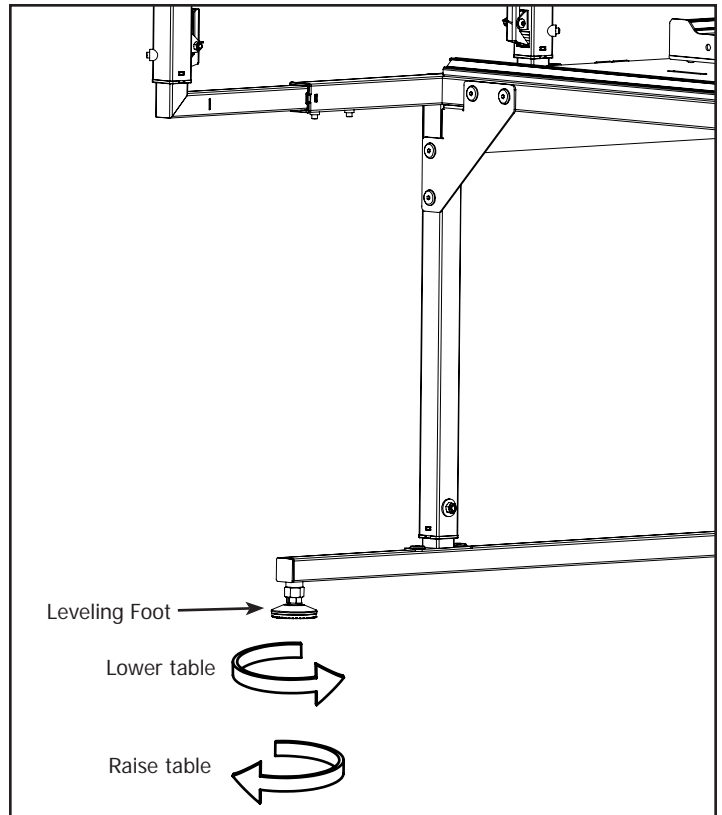

8-1 Adjust the Leveling Feet to level the frame and make sure it is stable. Adjust so the Carriage and Machine do not move on their own.

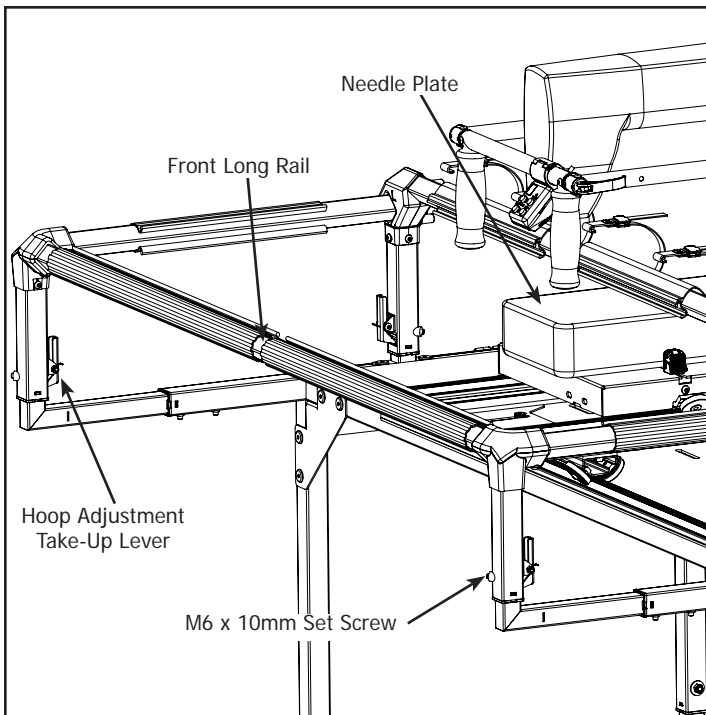

8-2 Adjust the Hoop so the top of the Front Long Rail and the Sewing Machine Needle Plate are level by loosening the M6 x 10mm Set Screws, pushing in on the Hoop Adjustment Take-Up Levers and raise or lower the Hoop. Tighten the M6 Set Screws when finished.

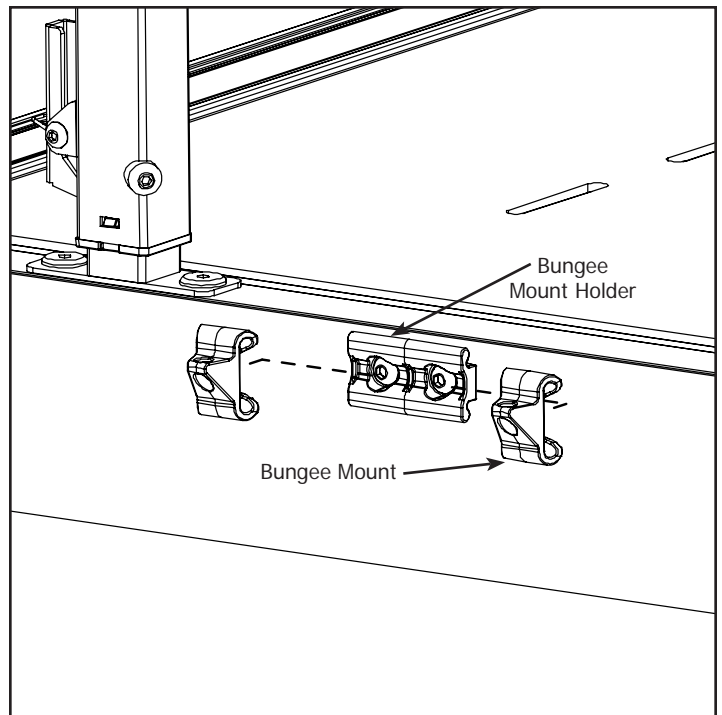

8-3 Slide the Bungee Mounts onto the Bungee Mount Holder.

Setup

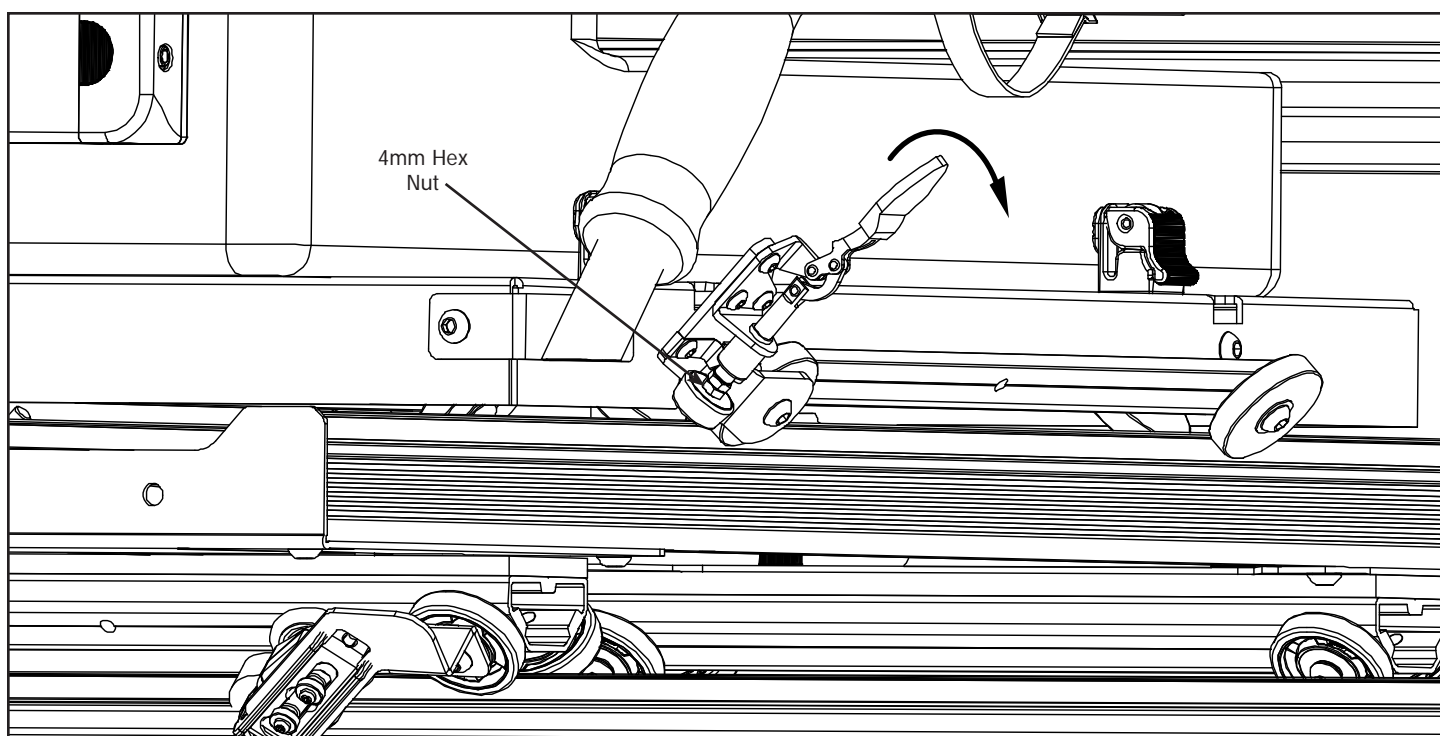

8-4 Rotate the Channel Lock handle down. To adjust the Channel Lock, loosen the 4mm upper Hex Nut. Twist the Rubber Foot clockwise until it is snug against the track. Turn the 4mm upper Hex Nut counterclockwise until it is snug against the Channel Lock barrel.

Note: Channel Locks are used to lock the Top Plate or the Carriage to assist in straight line stitching.

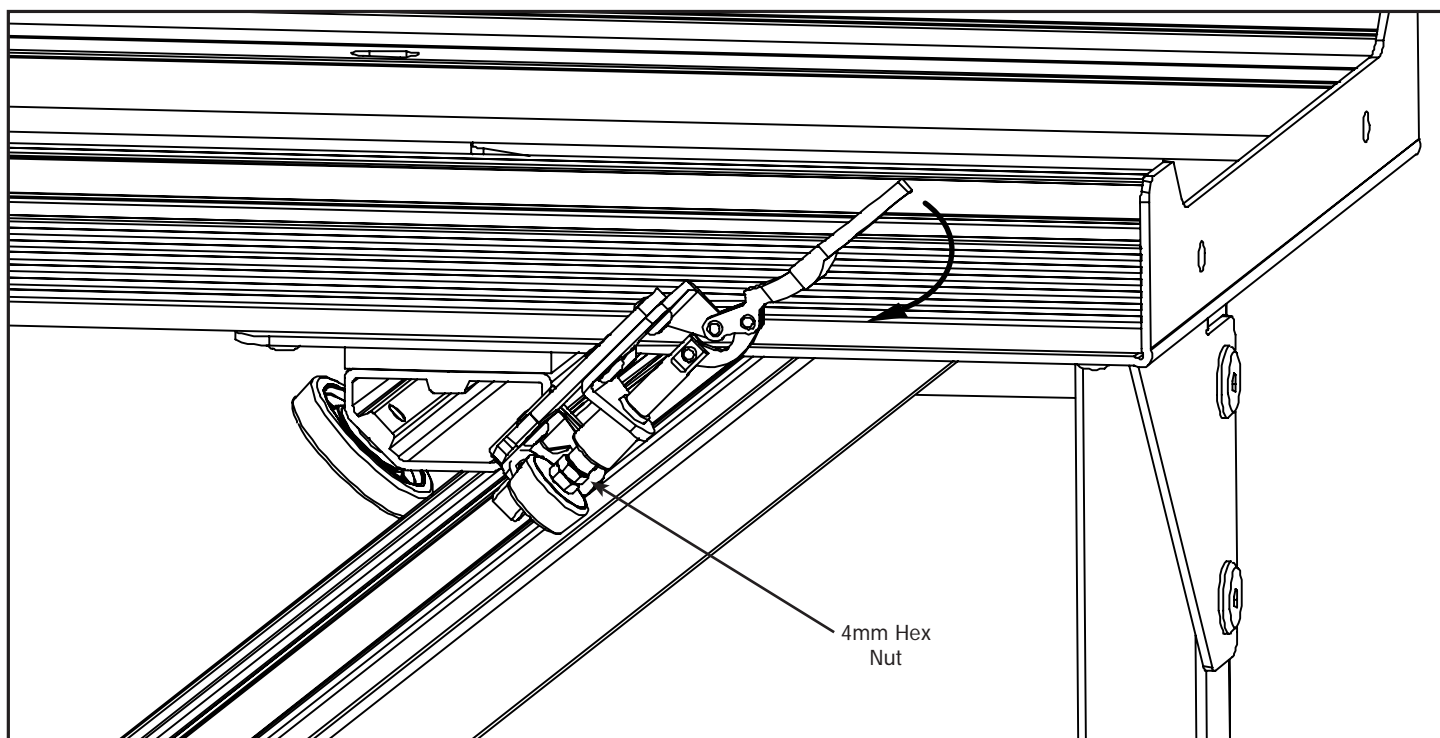

8-5 Rotate the Channel Lock handle down. To adjust the Channel Lock, loosen the 4mm upper Hex Nut. Twist the Rubber Foot clockwise until it is snug against the track. Turn the 4mm upper Hex Nut counterclockwise until it is snug against the Channel Lock barrel.

Note: Channel Locks are used to lock the Top Plate or the Carriage to assist in straight line stitching.

Fabric Setup

Step 9 - Fabric Setup

Tools Needed:

Pins (not included)

Fabric (not included)

Tape Measure (not included)

Fabric Cutting Tools (not included)

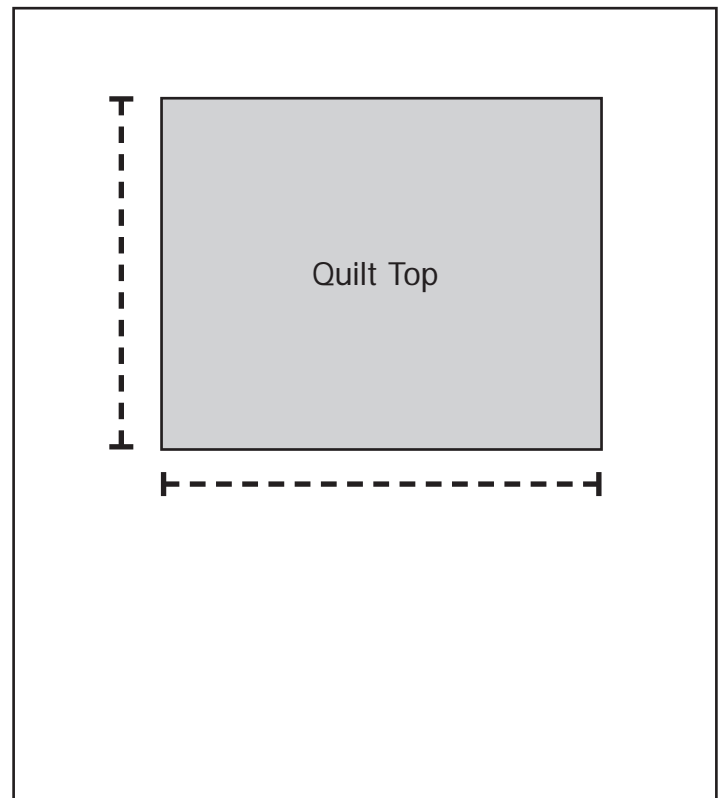

9-1 Measure the length and width of your quilt top.

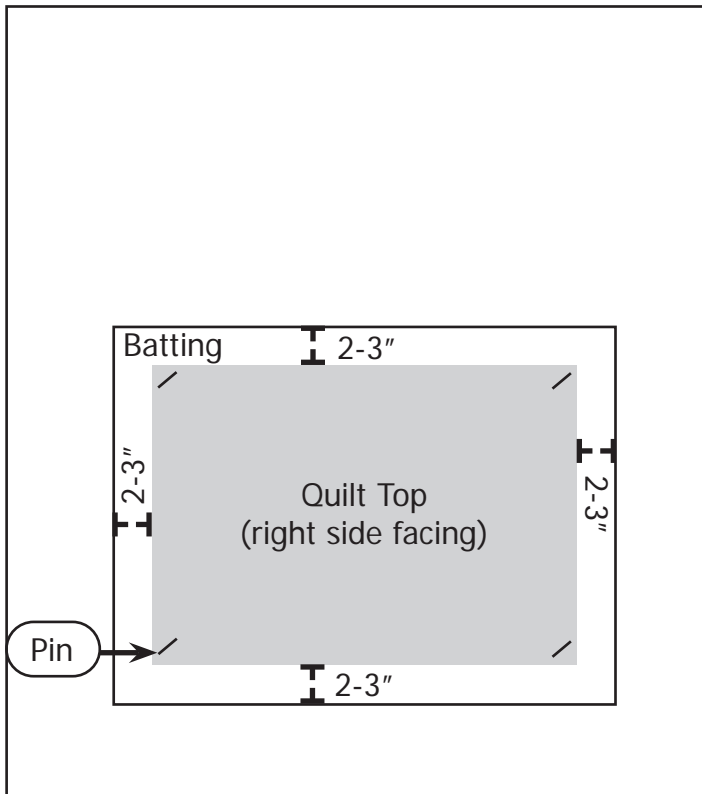

9-2 Cut your quilt batting so that it is 2-3 inches larger than the quilt top on all sides. **Pin** the quilt top right side up to the batting.

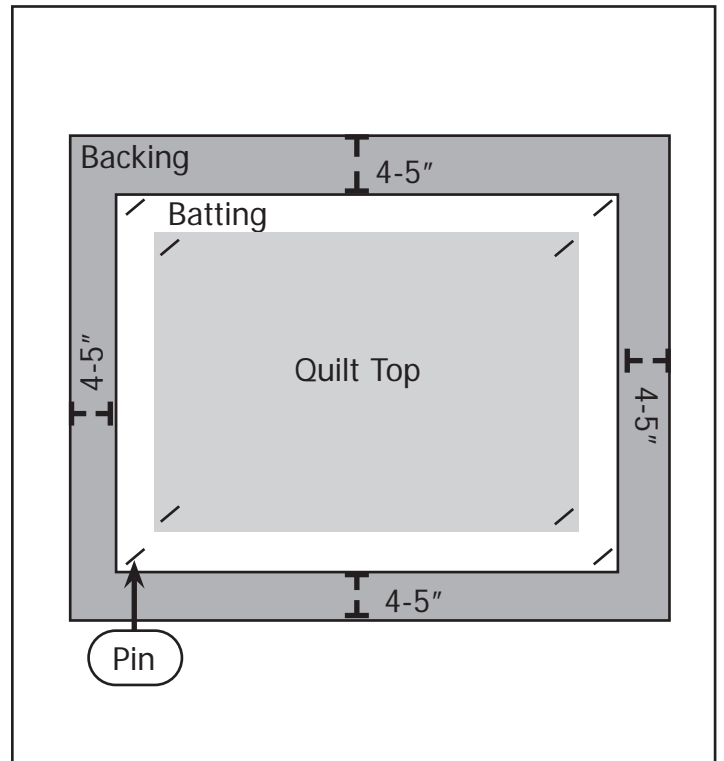

9-3 Cut your quilt backing so that the sides extend 4-5" out from the batting. **Pin** the backing to the quilt with the right side facing down, away from the batting.

Step 10 - Fabric Installation

Parts Needed:

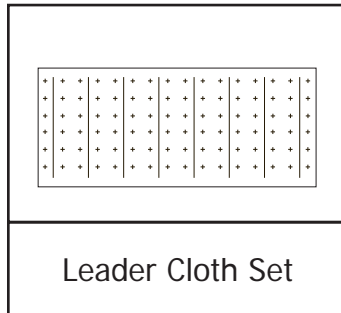
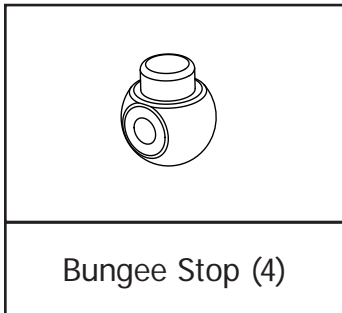
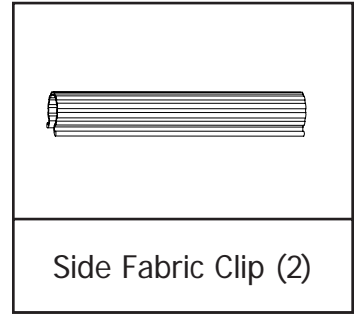
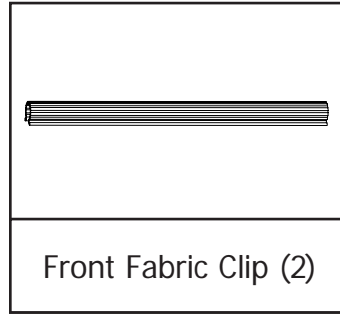
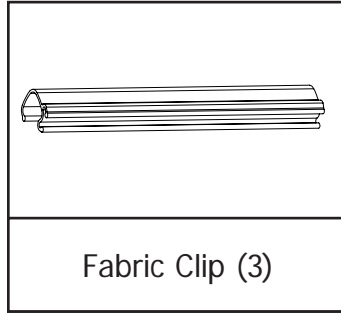
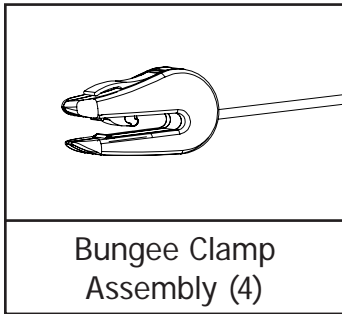

10-1 Find the center on your Back Rail Cloth Leader and Front Rail Cloth Leader and mark it. Find the center on your Backing on both the top and bottom edges. Lay the quilt sandwich with the quilt-top face down on a clean surface.

10-2 Match the center of each Cloth Leader with each center mark on the Backing and pin or baste from the center out to the end of the leader on both sides. Be sure there are no gaps between the pins.

10-3 Roll up your quilt sandwich starting from the bottom, leaving about a foot unrolled.

10-4 Carry the quilt to the machine and slide the unrolled portion under the needle and hopping foot, and over the top of the back rail in the throat of the machine.

10-5 Use the machine to assist with fabric positioning and alignment. Roll the sewing machine on the carriage as far back as you can. Then position the fabric so that the Quilt Top edge is approximately 1 inch away from the needle. While gliding the sewing machine across the frame check that the Quilt Top continues to be 1 inch away from the needle.

Fabric Setup

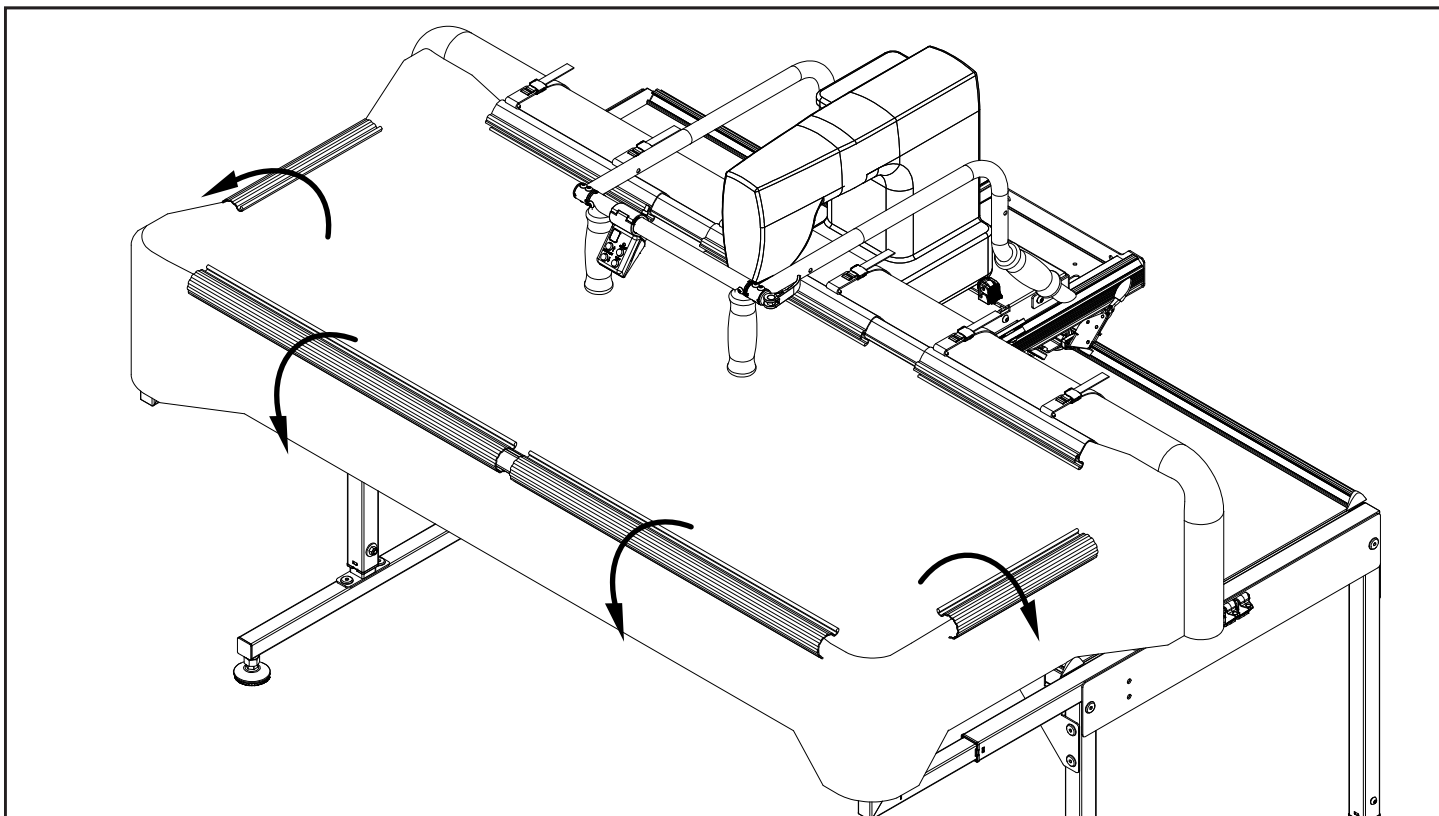

10-6 Install the (3) Fabric Clip. Pull Fabric snug and install the (2) Front Fabric Clips and (2) Side Fabric Clips. Rotate the Fabric Clips clockwise to tighten the fabric.

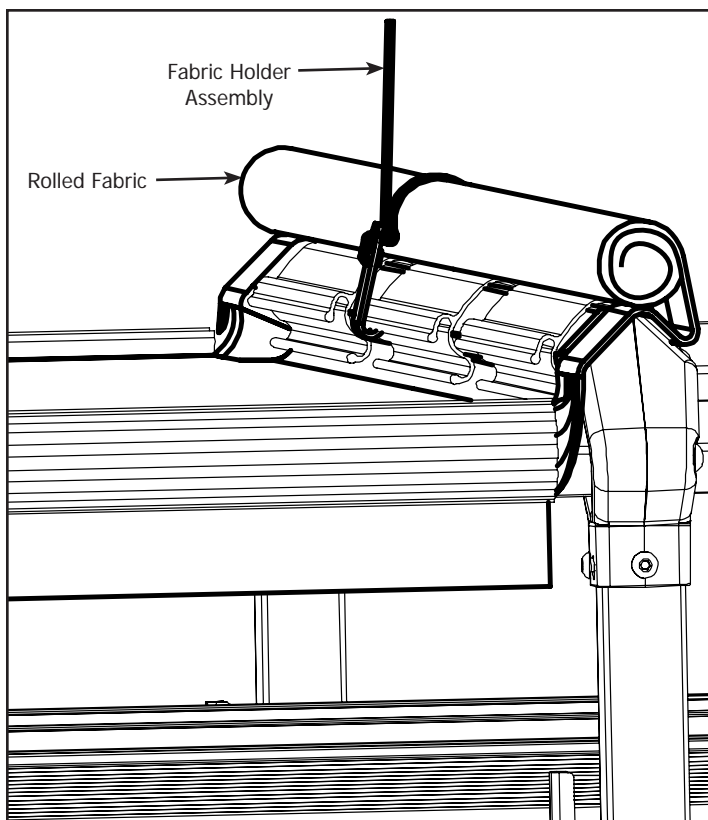

10-7 As you move your material, roll the finished area and secure with the Fabric Holder Assembly.

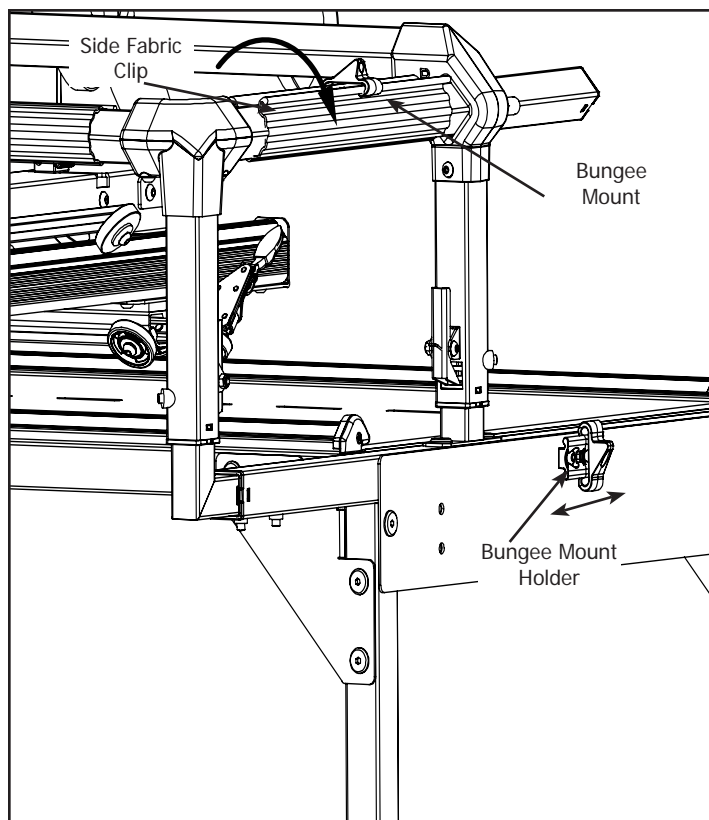

10-8 Slide the Bungee Mount off the Bungee Mount Holder and onto the Side Fabric Clip with the vertical face to the outside of the frame.

Fabric Setup

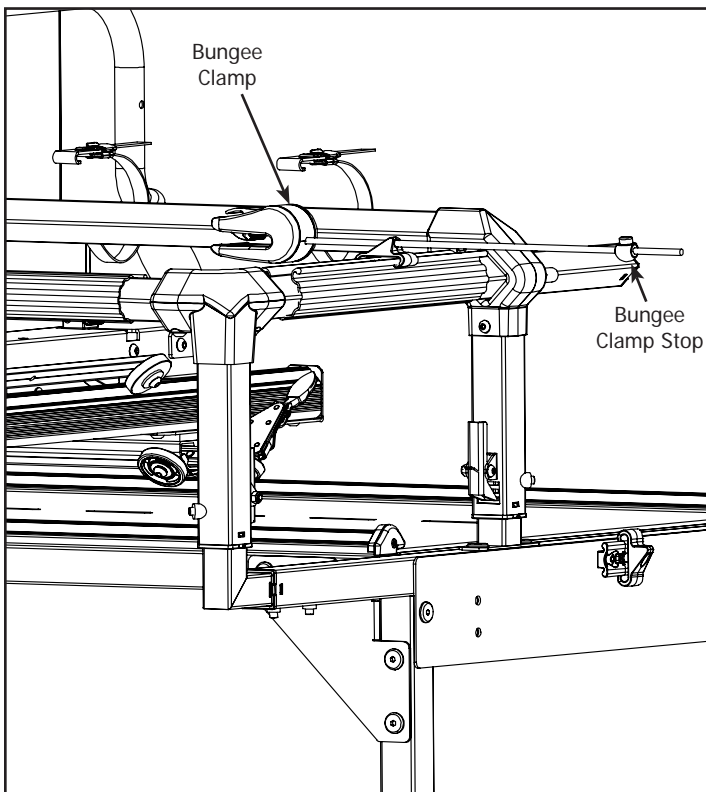

10-9 Insert the Bungee Clamp Cord through the Bungee Mount and the Bungee Stop.

Note: See Bungee Clamp instructions for attaching to fabric.

Care and Use

Quilting Tips:

- Be Careful not to sew too close to the edge, to prevent hitting the Bungee Clamps, or running off the edge of the quilt. Also, if you are using side leaders, avoid accidentally stitching the leader to your quilt.
- If your quilt will fit onto your frame length-wise attach your quilt's fabric to the rails along it's length. You will have to roll the quilt less often, since your work surface will be as large as possible. Also, the quilt will not be as large under the arm of the machine when you get to the end.
- Make sure to turn off your sewing machine any time you leave your quilting room.

Rails:

- Keeping the fabric on the Take-Up Rail, just slightly above the bed of the sewing machine, yields the best results. If the fabric is too high off the bed, thread and needle breakage may occur. If it is pressing down on the bed of the machine it will be difficult to roll the sewing machine on the frame.
- When rolling the quilt, pull the batting a little to each side to make sure that it is not bunching. After rolling and tightening all the rails, check under the quilt to see that the back is smooth.

Stitch Regulating:

- If the machine only appears to be stitch regulating in one direction, make sure the encoder cords are plugged in tightly on both ends. Make sure the encoder O-rings are contacting the track and rolling when the machine is moving on the carriage.

Bungee Clamps:

- If it is necessary to use the bungee clamps over the batting on your quilt, turn the bungee clamps upside down so the rubber grip in the clamp is gripping against the bottom fabric instead of the batting. Having the rubber grip clamp against the batting is less effective than having it clamp against the fabric.

Fabric Issues:

- Do not over tighten the fabric on the quilting frame. Stretching the fabric will result in a quilt that does not lay flat when it is finished.

Frame Cleaning:

- Regularly clean the wheels and track of your carriage and frame. Lint from the batting will build up quickly causing the carriage not to roll as smoothly and eventually damage the track.

Rolling Issues:

- Check the alignment on the carriage and the track so the carriages both roll smoothly. It is not necessary to make all the wheels touch as long as the carriage rolls smoothly. To readjust the carriage or track follow steps described in step 6.

Fabric Setup

Making Leader Cloths

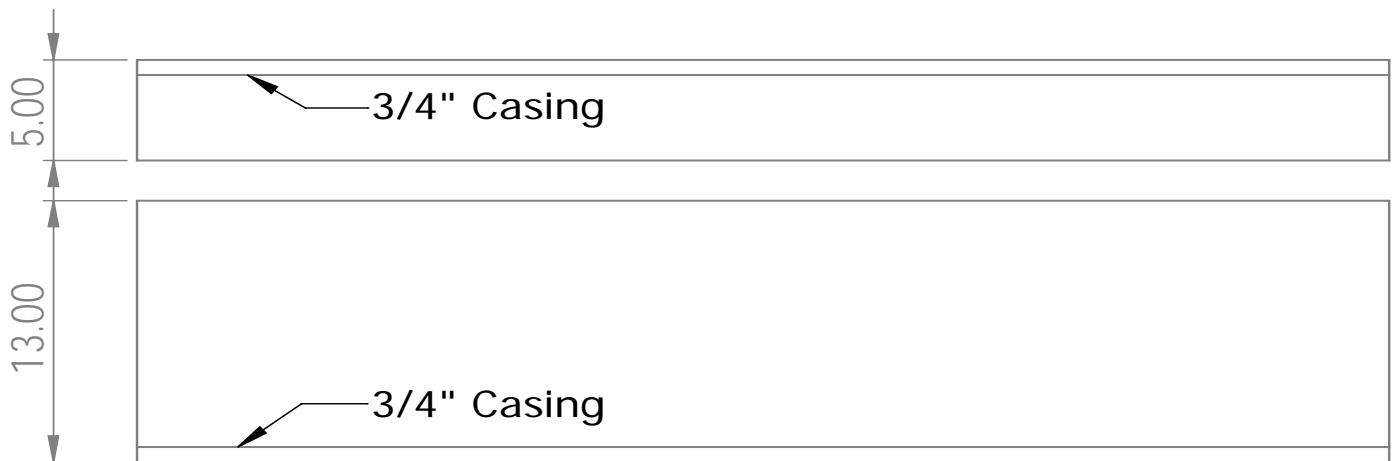

1: First, select your cloth leader material. We recommend using a good quality muslin or similar fabric that has a good thread count. Be aware, however, that if the fabric is too thick, it may prove more difficult getting it installed into the rail slot.

2: Surge or hem your cloth leaders on all sides.

3: Make cloth leaders in the widths shown. (The recommended length is 105", this length will accommodate any width of quilt that can be made on your Quilting Frame.)

4: Make a dashed line along the length of your leader about ½" in from the edge with a pen or marker. You will use this as a guide to help you insert your leader into the slot in straight line.

5: Mark each cloth leader at the center (length-wise).

6: Mark (or baste) a straight line about ½" in from the opposite (non-hemed, or non-dashed) end of the leader. This will be the line to which you attach your fabric layer.

7: Center your cloth leader lengthwise along the rail. Using Grace's Fabri-Fast™ System, take a piece of plastic tubing (cut to the appropriate length), and, holding your cloth leader to the slot (lining up the dashed line), press the tubing over the leader and into the slot. Use the Fabri-Fast tool to press the rest of the tube and fabric in quickly and easily. (If you have made a hem, line up this hem w/ tubing over the slot and press it into the slot using the Fabri-Fast tool.

8: With Cloth Leaders in place, pin your Quilt Fabric to the Leaders, rather than attaching it directly to the Rails.

Assembly

Top Plate Assembly - Optional Accessory

Parts Needed:

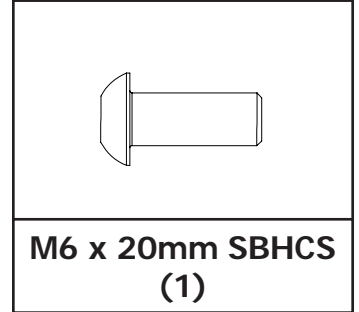
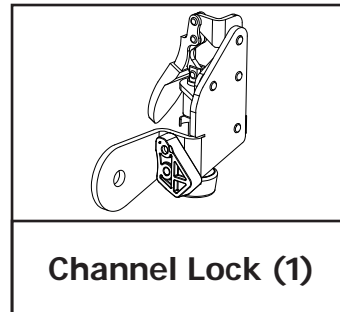
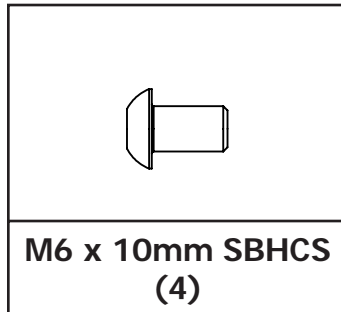
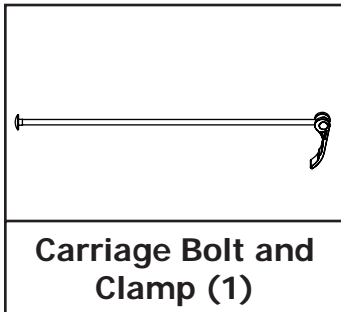
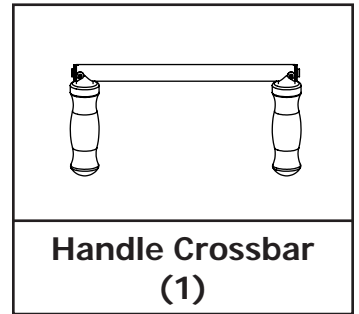
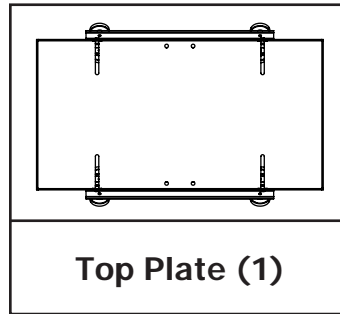
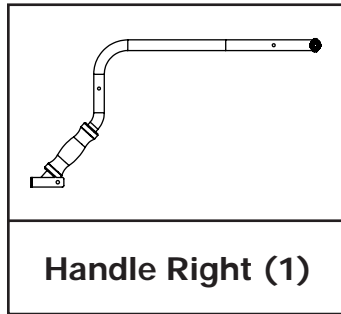
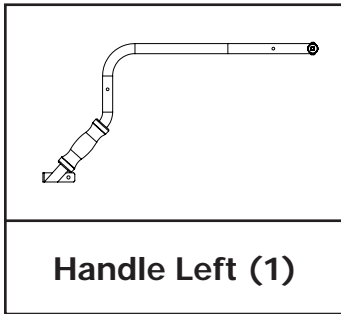

Tools Needed:

4mm Allen Wrench

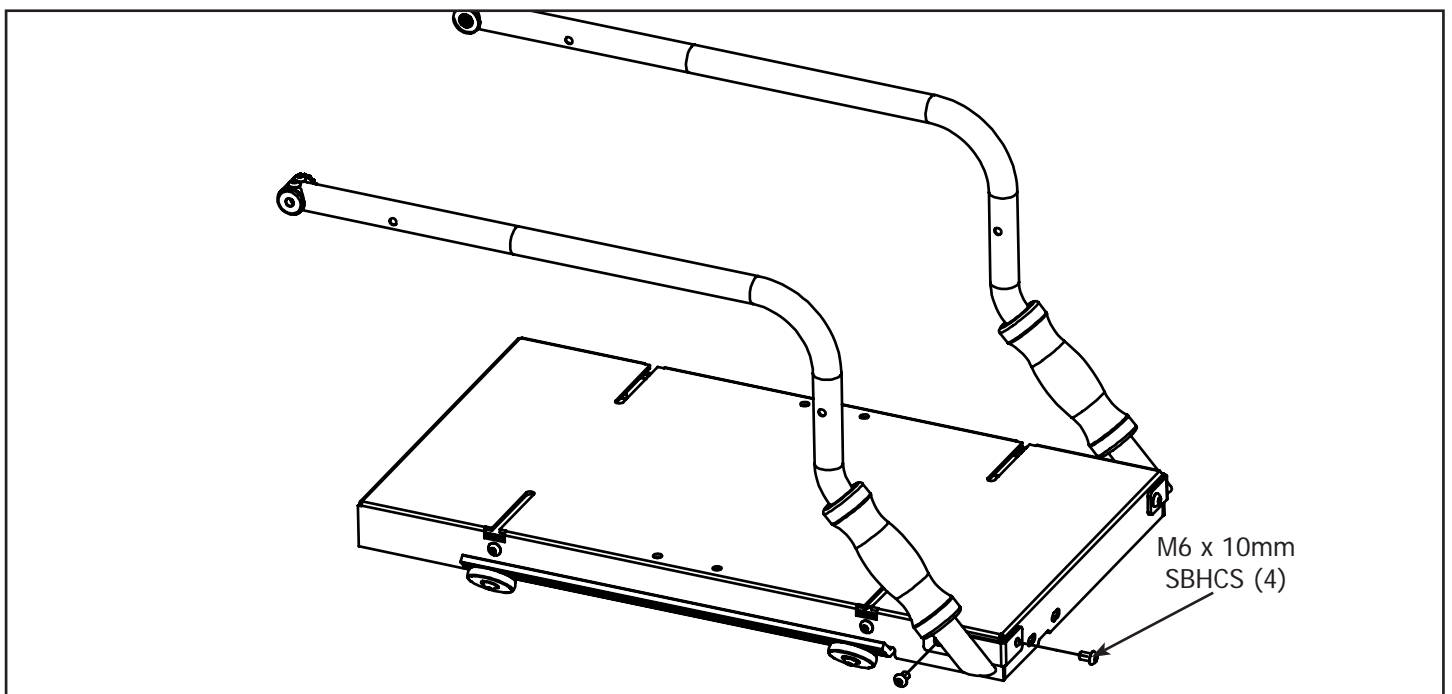

1 Attach Handles using (4) M6 x 10mm SBHCS.

Assembly

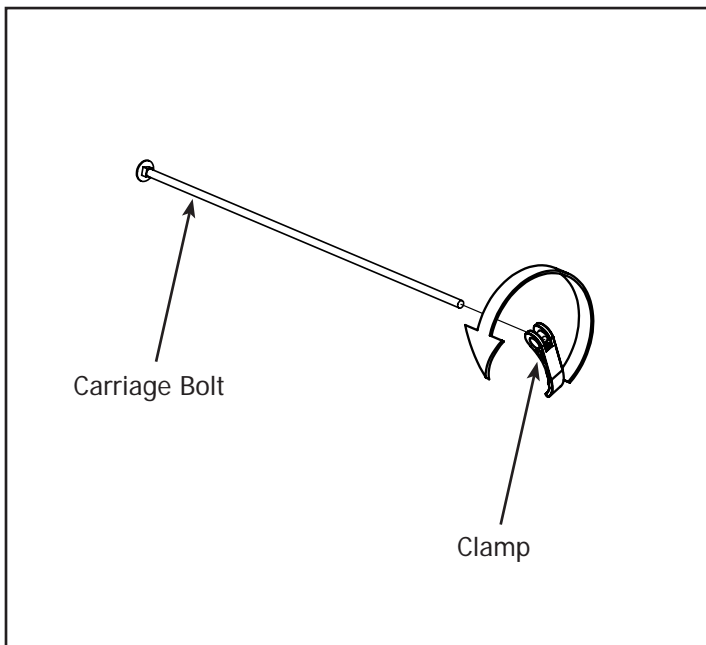

2 Un-thread Clamp from Carriage Bolt.

Note: The Carriage Bolt may need to be twisted to pass through both handles.

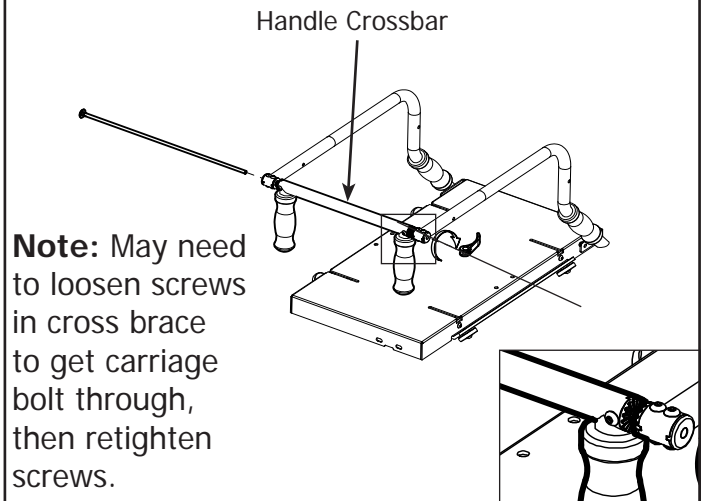

3 Assemble Cross Brace with the Handle Crossbar, Carriage Bolt, and Clamp.

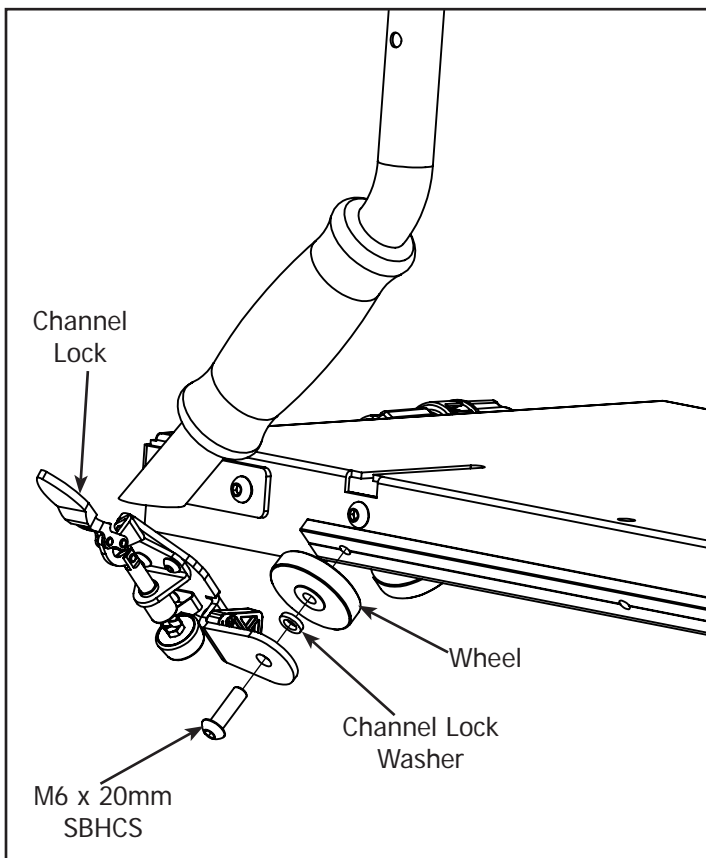

4 Remove the left rear M6 x 20mm SBHCS from the Top Plate and install the Channel Lock as shown above.

Assembly

Top Plate & Machine Installation - Optional Accessory

Parts Needed:

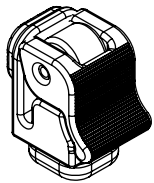

**Sewing Machine
Clamp (4)**

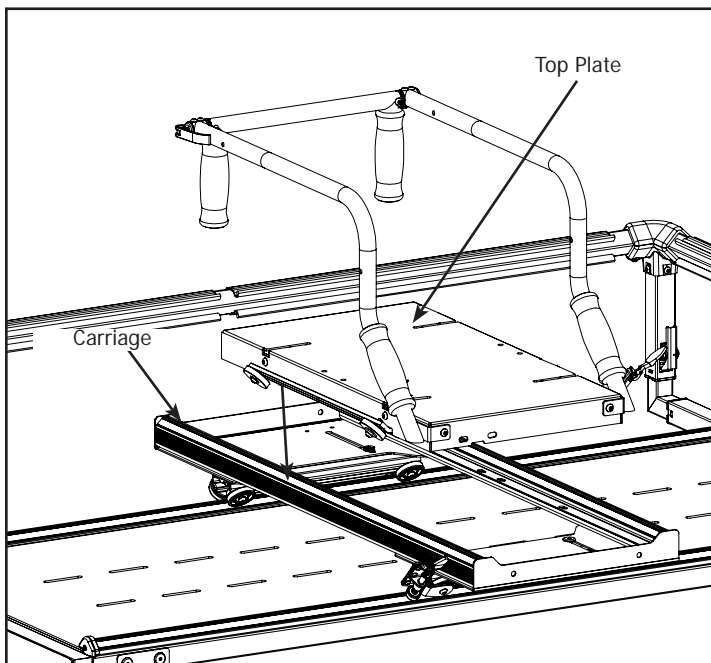

1 Place the Top Plate on the Carriage

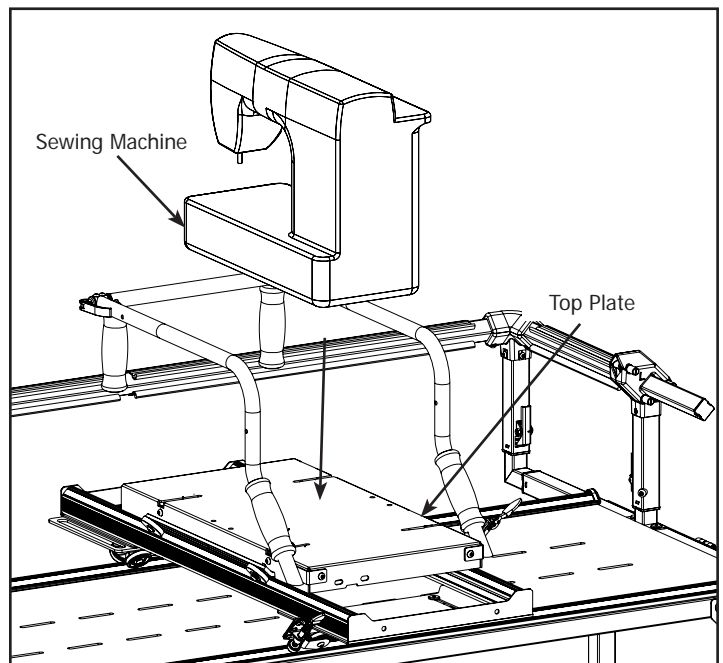

2 Place the Sewing Machine onto the Top Plate.

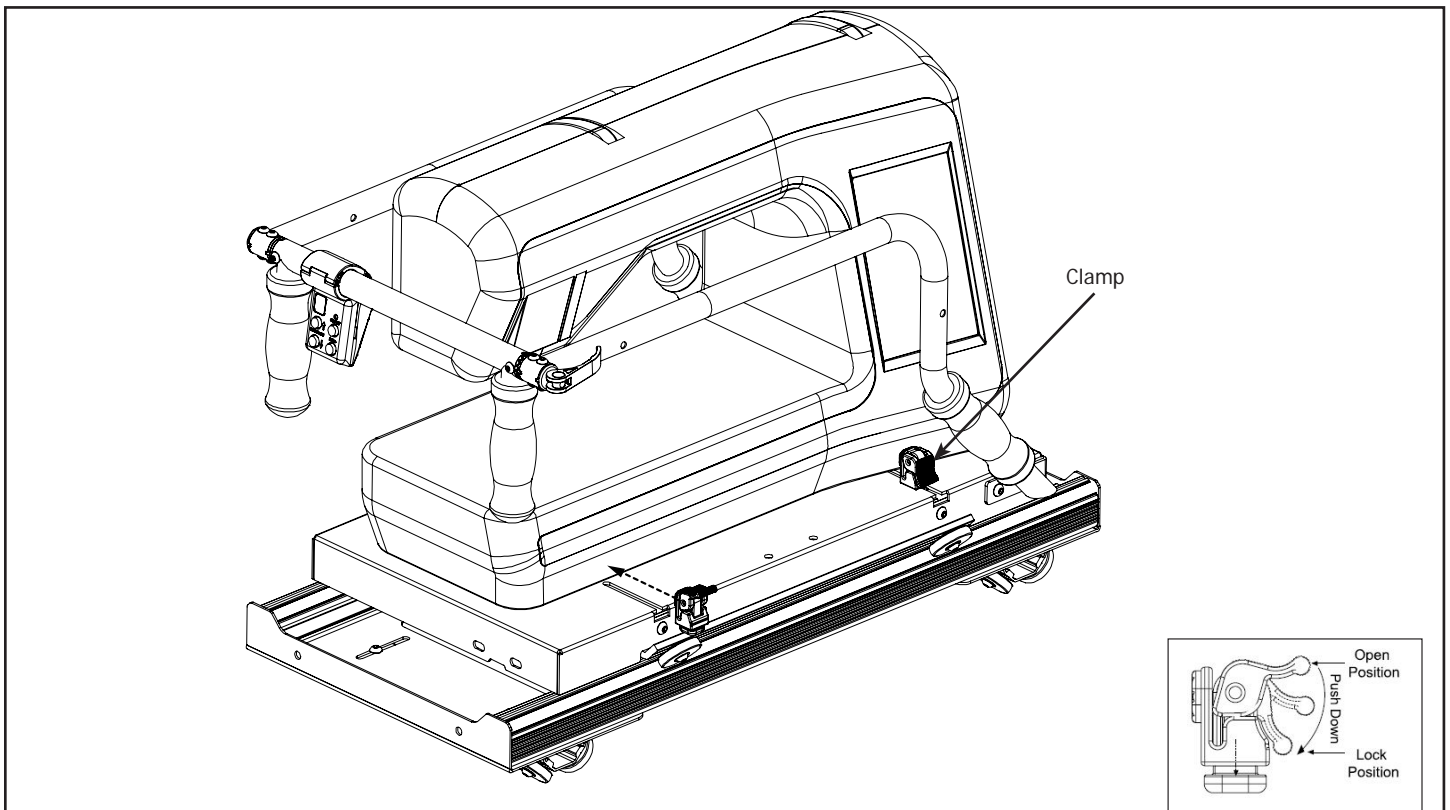

3 Center Machine on Top Plate from side to side and make the back of the throat of Sewing Machine line up with the vertical part of the handles. Slide each Clamp into the grooves on the Top Plate and lock against Machine.

Note: Some Larger machines do not require Clamps.

Notes

This image shows a single sheet of white paper with horizontal ruling lines. The lines are evenly spaced and run across the width of the page. There are no margins, text, or other markings on the paper.

The Grace Company
2225 South 3200 West
Salt Lake City, UT 84119
Phone: 1-800-264-0644
Fax: 801-908-8888

