

Grace 19SD

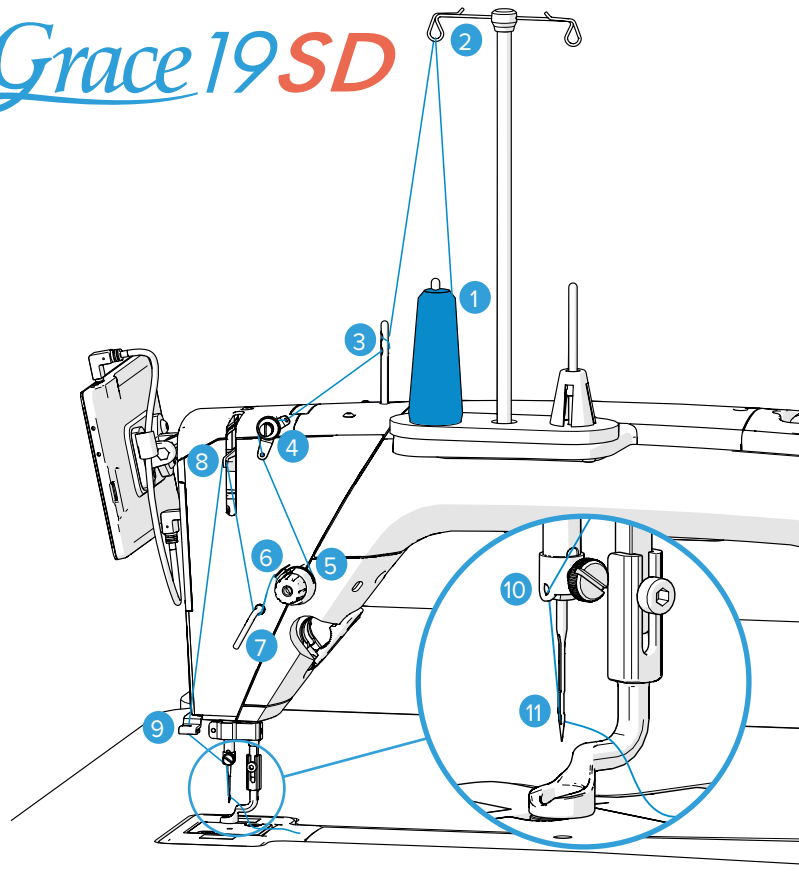

Thread Guide

- 1 Thread cone
- 2 Thread mast guide loop
- 3 Thread guide rod
- 4 Small tensioner
- 5 Large tensioner
- 6 Check spring
- 7 Thread guide
- 8 Take-up lever
- 9 Bottom thread guide
- 10 Needle bar eyelet
- 11 Needle eye

Starting a New Project?

1. Gather fabric, batting, thread, and needles.
2. Clean your machine and fabric sensors.
3. Oil the hook assembly.
4. Replace the needle (every 8 hours of use).
5. Wind, tension, and load the bobbin.
6. Thread the machine.
7. Prepare your quilt sandwich.
8. Set the hopping foot height using your quilt sandwich.
9. Test your sewing tension using scrap fabric of the same materials as your project.
10. Set the bobbin estimator.
11. Choose your quilting mode and set your stitch length/speed settings.

See your machine manual for details on these tasks.

Quilt Sandwich

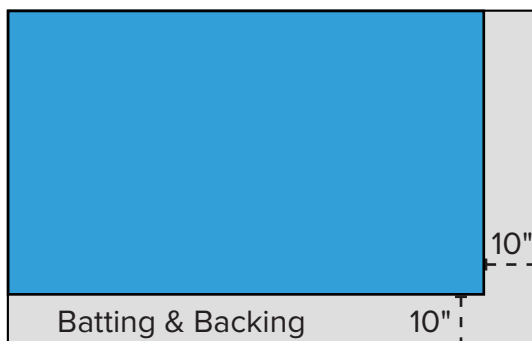

Recommended sizing:

Backing: 10" larger than the quilt-top.

Batting: Same size as backing.

Help Files

Tap the Menu icon and select Help to get on-screen instructions for:

- Threading
- Bobbin winding
- Thread tension
- Cleaning and oiling machine
- More issues

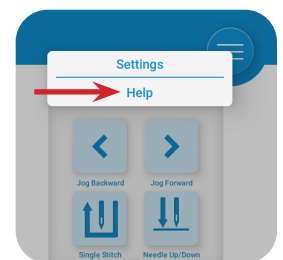

Needle Information

Use a straight needle.

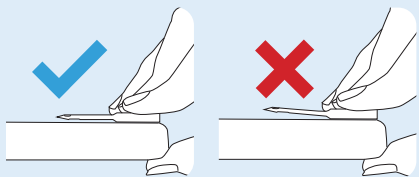

Needle Style: DPx5 MR, 134 MR, 1955 MR **Bobbin Type:** M-Class

Size: **Thread Size and Type:**

14/90	mono-filament, 100 wt. silk, 60 wt. polyester
16/100	mono-filament, 60 wt., 50 wt. polyester or cotton thread
18/110	40 wt. cotton and polyester, 30 wt. cotton and polyester
20/125	any thread 30 wt. or heavier

Bobbin Case Loading

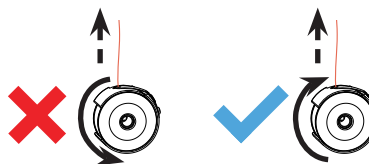
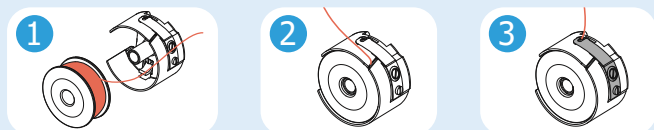

Bobbin rotates clockwise when thread is pulled.

Bottom Thread Tension

Tension test: Place the bobbin flat on your palm and pull the thread up.

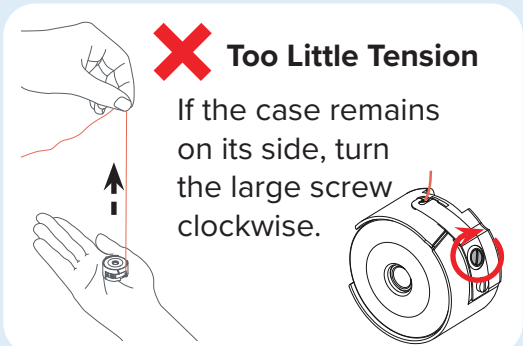
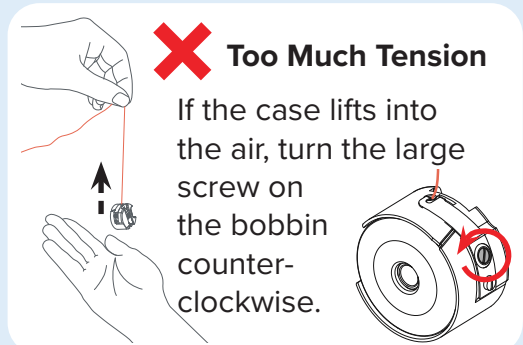
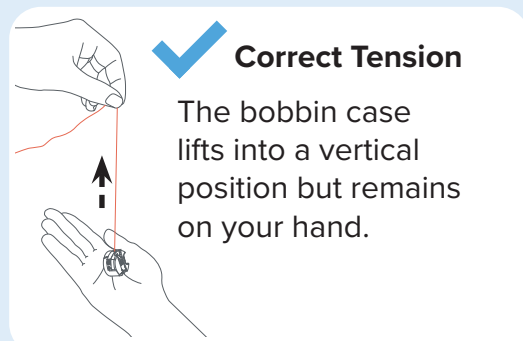

Top Thread Tension

Note: Set bottom thread tension first. Test top thread tension on scrap fabric.

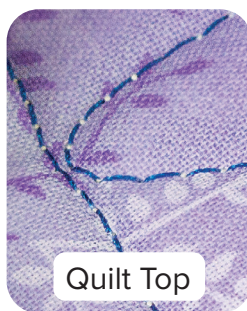

○ Quilting Screens

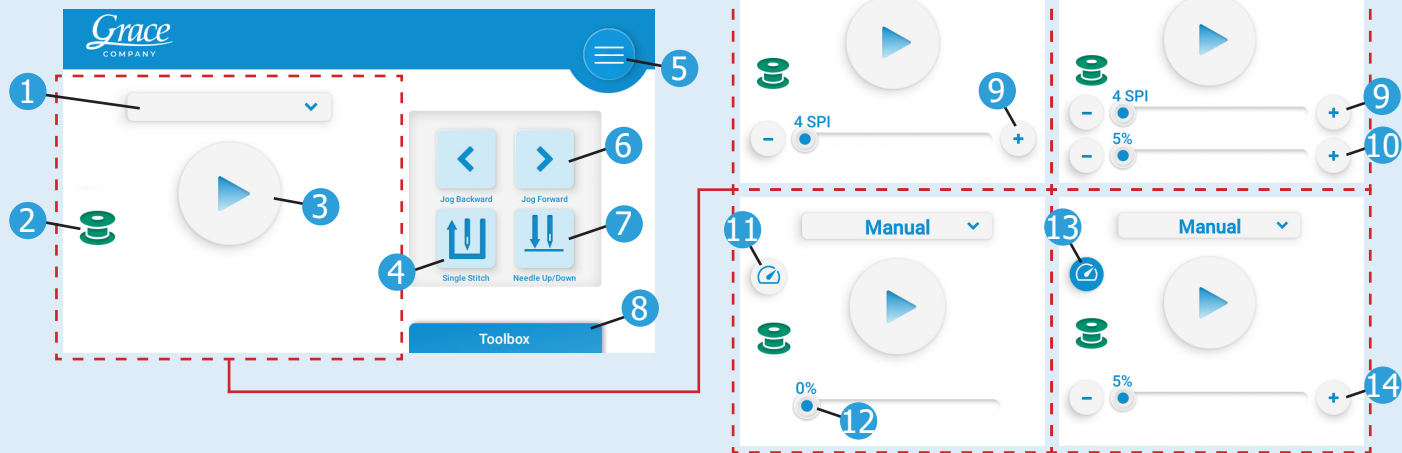

1 Quilting Mode

Press the drop-down to select a sewing mode:

- Precise
- Cruise
- Manual

2 Bobbin Level Estimate

Estimated bobbin fill level.

- Above 21%
- Between 11–21%
- Under 10%

Indicator does not show if turned off in Bobbin Estimator.

3 Start/Pause Stitching

Press to start or stop stitching.

4 Single Stitch

Creates a single stitch in place.

5 Menu Selection

Tap to open the Settings and Help menus.

6 Jog Needle

Press [$<$] or [$>$] to move the needle incrementally.

7 Needle Up/Down

Press to move the needle to the highest or lowest position.

8 Toolbox

Tap to open the calculator, bobbin estimator, and project (stitch counter) tool.

9 Stitch Length

Displayed in Stitches Per Inch (SPI) or Centimeter (SPC). Change units in Settings.

10 Minimum Speed

Machine stitches continuously at this speed but can increase speed when fabric moved over sensors.

11 Speed Limit Off

Use foot pedal to control machine speed.

12 Manual Speed

Displays the stitch speed as set by the foot pedal. It is a percentage of the total possible speed.

13 Speed Limit On

14 Maximum Speed

Set the speed limit. Machine will not exceed limit.

Toolbox

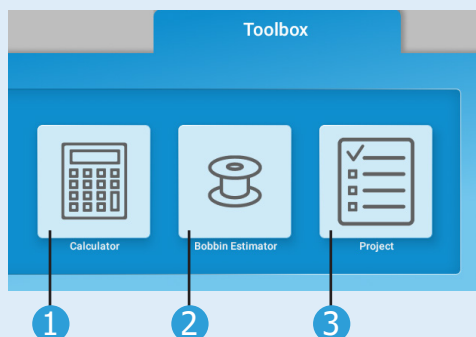

1 **Calculator** - Quick tool for calculating.

2 **Bobbin Estimator** - Shows estimated bobbin fill level.

3 **Project** - Track stitch count for project.

Overspeed Alarm

If you move your fabric too quickly for stitch regulation to work, the overspeed alarm sounds, a red LED light shines on the needle area, and the Start/Pause button turns red. Slow down for regulation to work. You can disable the alarm in Settings.

Hopping Foot Height

Set the hopping foot height for each project:

1. Slide your quilt sandwich under the needle.
2. Lower the needle.
3. Loosen the hopping foot screw.
4. Press down gently on the hopping foot.
5. Tighten the hopping foot screw.

See machine manual for details.

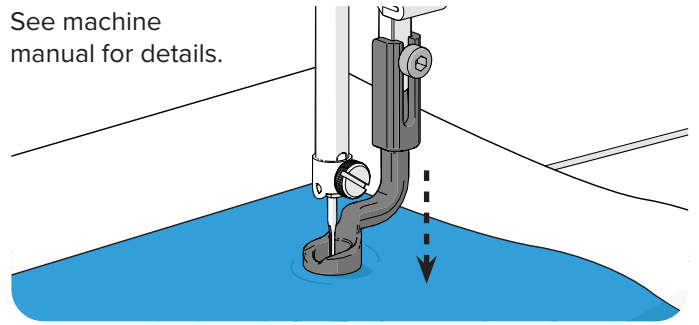

Settings Menu

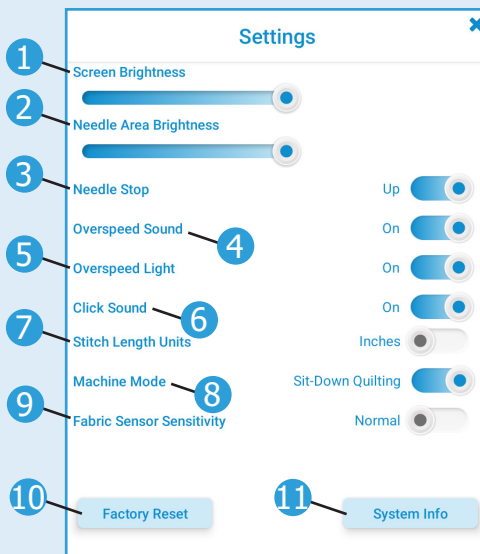

1 Screen Brightness

Controls display brightness.

2 Needle Area Brightness

Controls brightness of the light in needle area.

3 Needle Stop

Sets the needle to stop in the Up or Down position when stitching is inactive.

4 Overspeed Sound

Sets the overspeed alarm on or off.

5 Overspeed Light

Sets the red overspeed warning light on or off.

6 Click Sound

Sets the click sound when you press buttons on or off.

7 Stitch Length Units

Sets the units to inches or centimeters.

8 Machine Mode

Switches from sit-down quilting to frame quilting.

9 Fabric Sensor Sensitivity

Switches from Normal to High. Only use High with reflective fabrics that cause sensor malfunctions.

10 Factory Reset

Returns your display to the original factory settings.

11 System Info

Shows the display and machine firmware versions.

See machine manual for details.

Fabric Sensors

Stitch regulation uses the fabric sensors to work properly. For best results when quilting:

- Keep the sensors free of lint and fingerprints. Use a soft, microfiber cloth to clean them as needed.
- Keep pin tips on top of your quilt to prevent scratching the sensors.
- Use smooth-textured fabrics with short fibers. Fabrics with long fibers, such as faux fur, are not recommended.
- Remove lint from your backing fabric, especially from dark-colored fabrics.

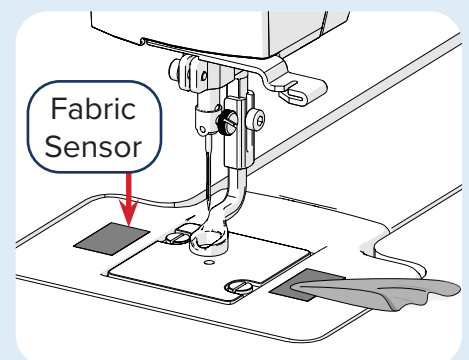

Grace
COMPANY

1-801-485-6688