

Thread Guide

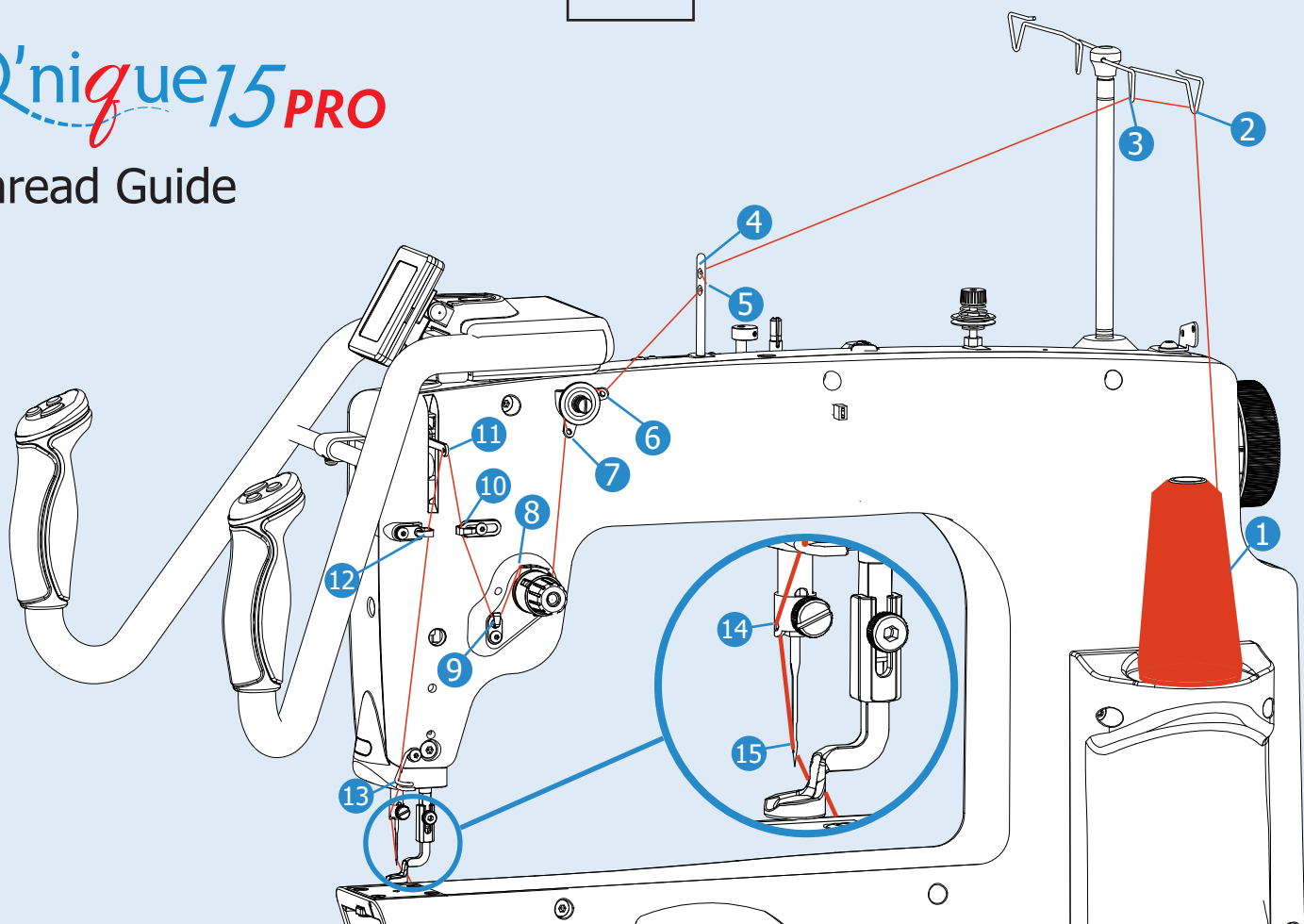

Troubleshooting

If your thread is breaking...

- Replace your needle if it is bent or burred. Use the needle magnet to align and install your needle straight.
- Follow the "Top Thread Tension" guide on the back to correct your thread tension.
- Check that your machine is threaded correctly using the "Thread Guide" above.
- Follow the "Bobbin Guide" on the back for threading, tensioning, and installing the bobbin case.
-
- Check the hopping foot height.
- Adjust the height of the take-up rail on your quilting frame to be 1/4 inch above the needle plate.
- For more help call 1(800) 264-0644 or e-mail support@graceframe.com.

If your machine is skipping stitches...

- Replace your needle if it is bent or burred. Use the needle magnet to align and install your needle straight.

- Follow the "Top Thread Tension" on the back guide to correct your thread tension.
- Check the hopping foot height.
- Adjust the height of the take-up rail on your quilting frame to be 1/4 inch above the needle plate.
- For more help call 1(800) 264-0644 or e-mail support@graceframe.com.

Needle Information

Use a straight needle.

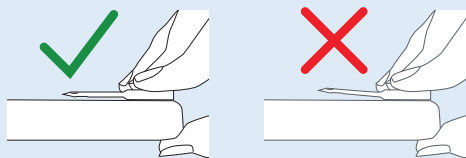

Needle Style: 135x5, DPX5

Bobbin Type: M-Class

(Equivalent European Needle Styles: 134, 135x7, 797, SY 1955)

Size: Thread Size and Type:

14/90	mono-filament, 100 wt. silk, 60 wt. polyester
16/100	mono-filament, 60 wt., 50 wt. polyester or cotton thread
18/110	40 wt. cotton and polyester, 30 wt. cottons and polyester
20/125	any thread 30 wt. or heavier

Bobbin Guide

Place the bobbin in the bobbin case so that when you pull the thread, the bobbin rotates clockwise.

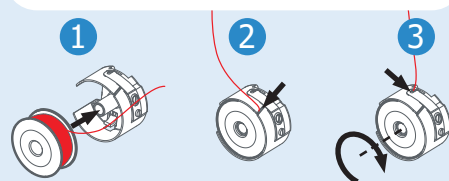

Tension Test: Hold the bobbin case in your hand and pull the thread up.

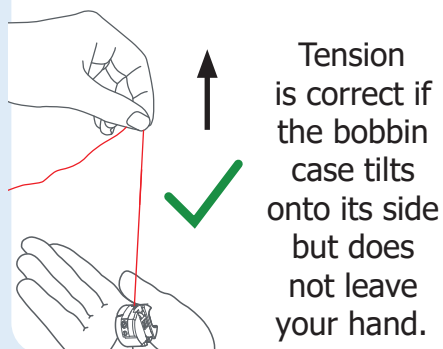

Set the bobbin tension first, and then adjust the top thread tension.

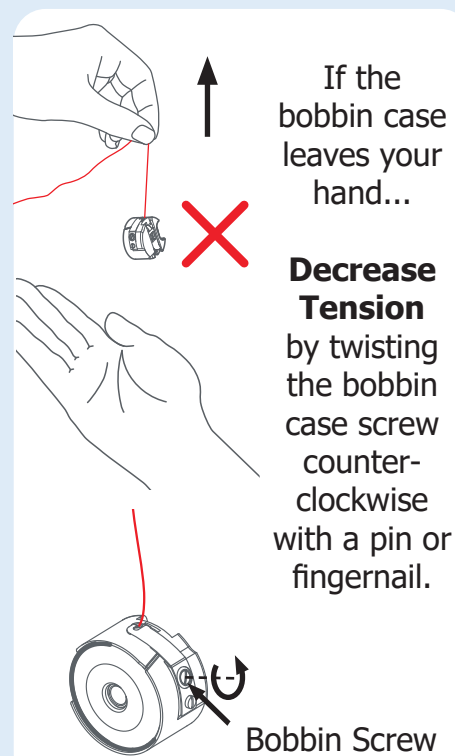
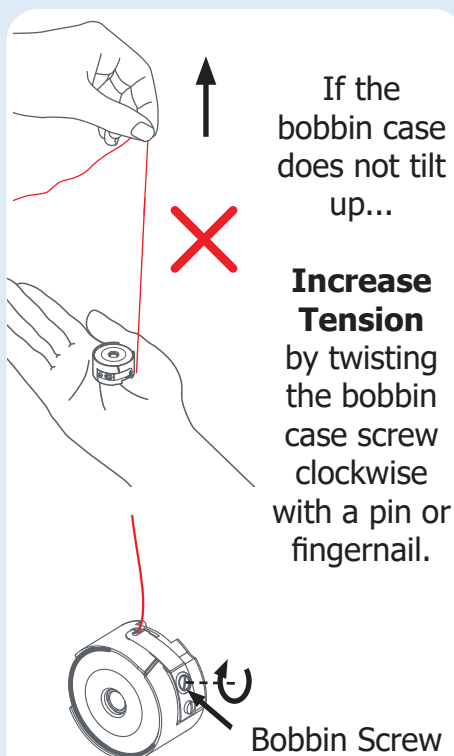

Top Thread Tension

Set the bobbin tension first (see above).

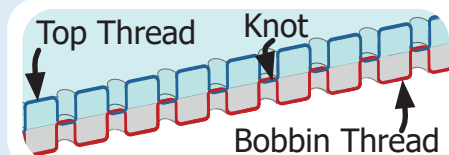

Correct thread tension

The top and bobbin thread knot in the middle of the fabric layers.

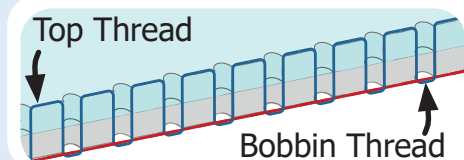

If the top thread is pulled through the bottom layer of fabric, increase tension.

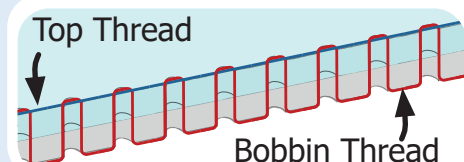
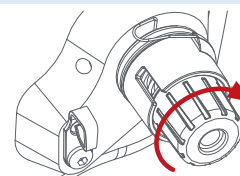

If the bobbin thread is pulled through the top layer of fabric, decrease tension.

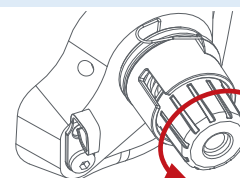

Sewing Button Controls

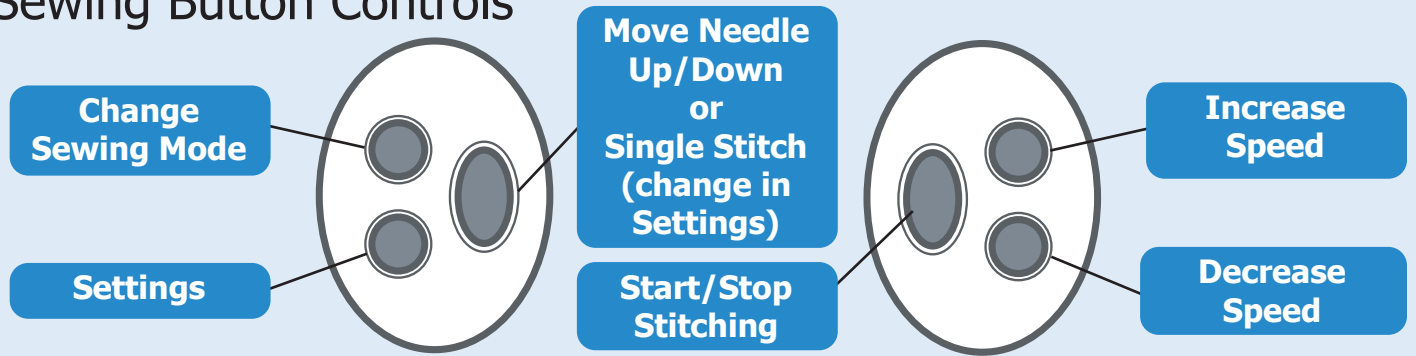

*These buttons may be reversed in Settings for left-handed quilters.

Sewing Screen

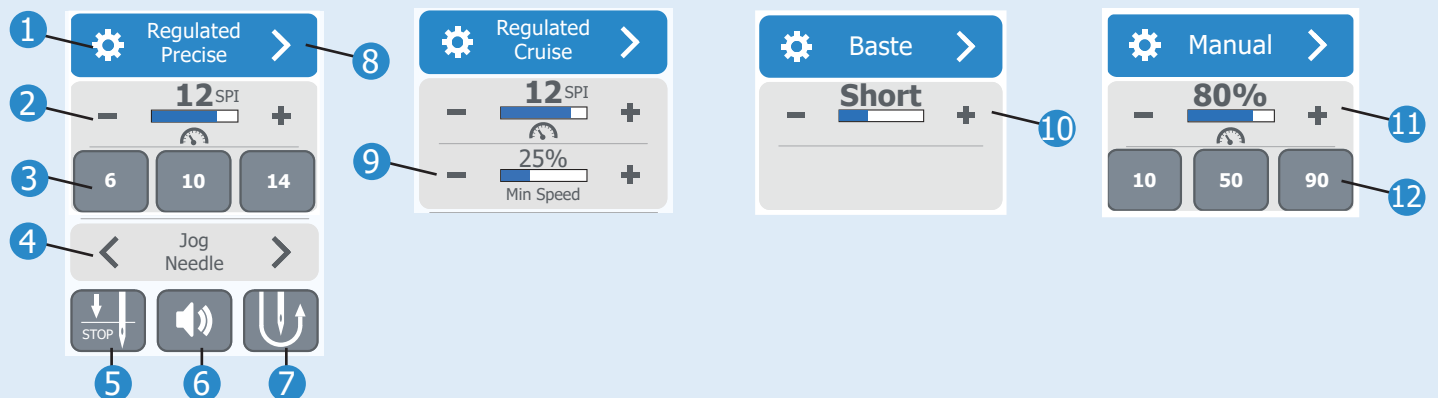

1 Settings

2 Stitch Length

Displayed in Stitches Per Inch (SPI) or Centimeter (SPC) (see Settings to set the unit measurement). Press [-] to decrease SPI/SPC and [+] to increase SPI/SPC.

3 SPI/SPC Presets

Press to set the SPC/SPI shown.

4 Jog Needle

Press [<] or [>] to move the needle incrementally.

5 Needle Stop Indicator

Shows if the needle will stop sewing in the [Up] or the [Down] position. Press to switch to [Up] and [Down].



[Up]



[Down]

6 Over-speed Indicator.

Press to switch audible signal [On] and [Off]. Icon will change [Red] if you move your machine faster than it is able to make even stitches.



Machine Inactive



Machine Active



Over-speed: Move machine slower.

7 Full Stitch/Half Stitch

Pressing this button to create a full stitch, or a half stitch. Change which button is active in Settings.



[Full Stitch]



[Half Stitch]

8 Sewing Mode

Press [>] to switch to Precise, Cruise, Manual, and Baste.

9 Minimum Speed

Shown as a percentage of the machine's highest speed, ranging from 5% to 25%. Press [-] to decrease stitch speed and [+] to increase stitch speed.

10 Baste Length

Press [-] to decrease stitch length and [+] to increase stitch length.

11 Manual Speed

Displayed as a percentage of the highest speed. Press [-] to decrease speed and [+] to increase speed.

12 Manual Speed Presets

Press to use that stitch speed. Press and hold to set.

Settings Button Controls

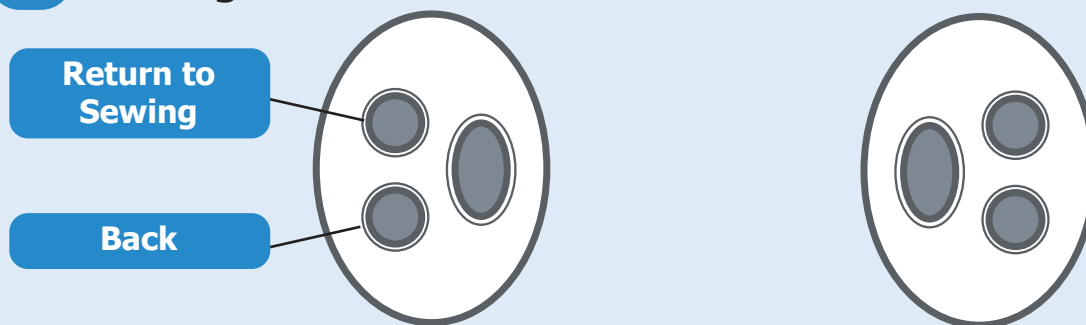

*These buttons may be reversed in Settings for left-handed quilters.

Settings Screen

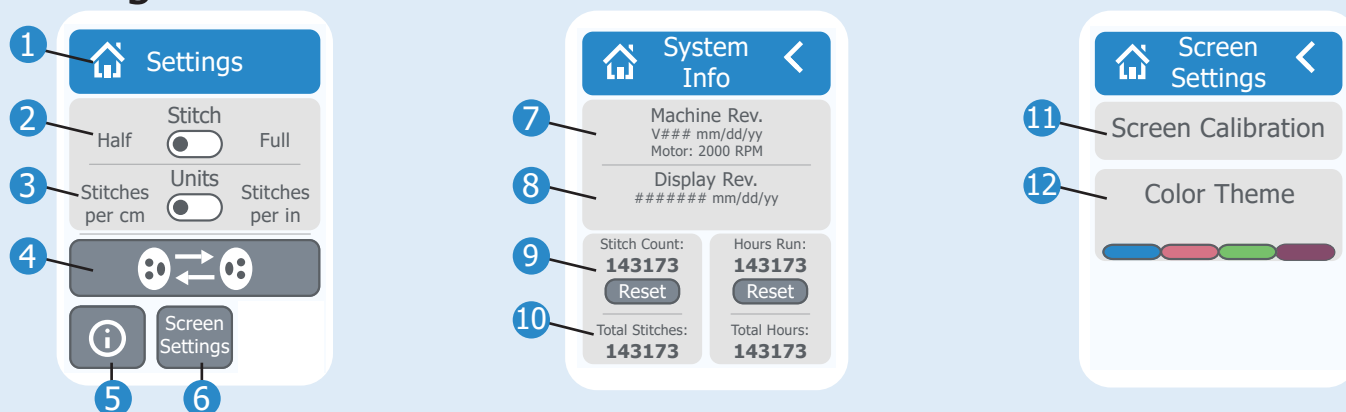

1 Return to Sewing

2 Stitch Button Setting

Change which button is active on the Sewing Screen and on the handle button.



[Full Stitch]



[Half Stitch]

3 Units

Change speed units from SPI to SPC on the Sewing Screen.

4 Reverse Handle Buttons

Reverse the Left and Right Handle Button Controls. This is useful for Left-handed Quilters.

5 System Information

6 Screen Settings

7 Machine Revision Information

8 Display Revision Information

9 Stitch Count

Press [Reset] to reset the Stitch Count. Total Stitches will not reset.

10 Hour Count

Press [Reset] to reset the Hour Count. Total Hours will not reset.

11 Screen Calibration

Use this setting if buttons aren't activated correctly when pressed.

12 Color Theme

Choose a color theme for your screen.