

Q'nique Hopping Foot Set

Installation Instructions

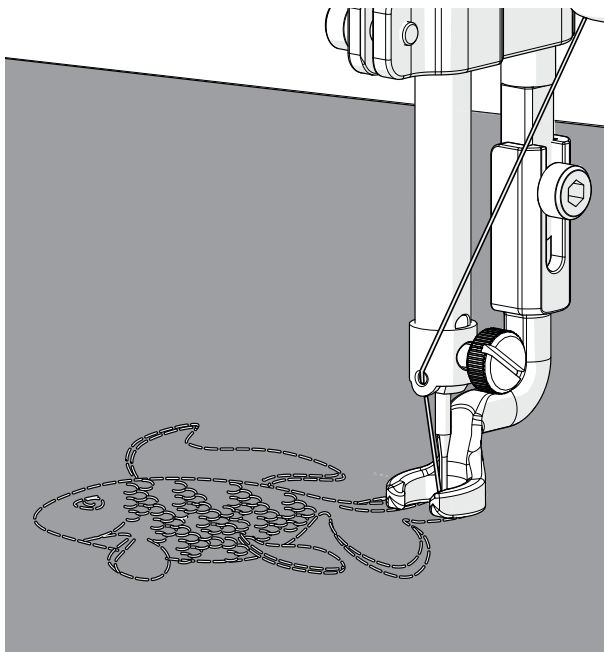

V 2.0

Copyright Jan 22, 2021

Grace
COMPANY

IMPORTANT: READ FIRST

Check the style of hopping foot currently installed on your machine.

If it is not the most recent version, you will need to purchase the Standalone Hopping Foot Collar on the Grace Company website before you can use this accessory.

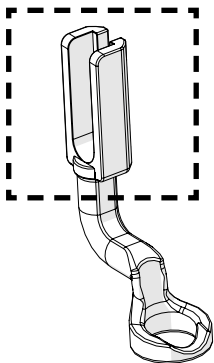

Continue with these instructions.

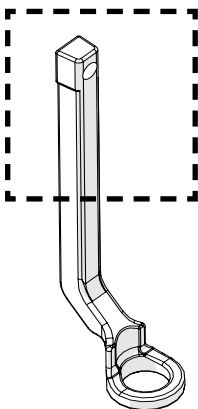

Visit www.graceframe.com
to purchase the
**Standalone Hopping
Foot Collar.**

Included Parts and Tools

Micro-Stippling Foot

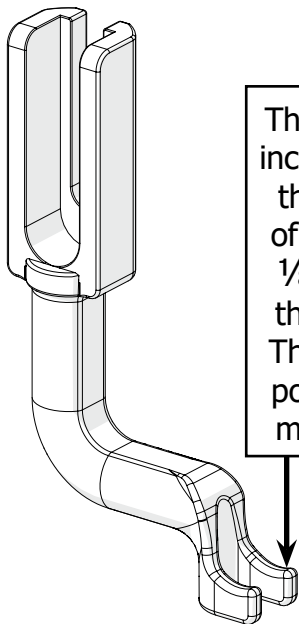

The needle is $\frac{1}{4}$ inches away from the outer edge of the toes, and $\frac{1}{8}$ inches from the inner edge. This helps when positioning your micro-stippling.

SMP-04-11708

Included Parts & Tools (continued)

Open-Toe Foot

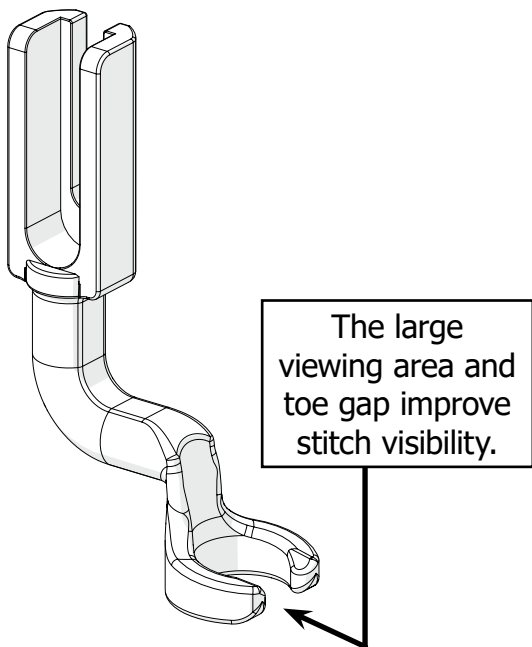

SMP-04-11707

Included Parts & Tools (continued)

Ruler Foot

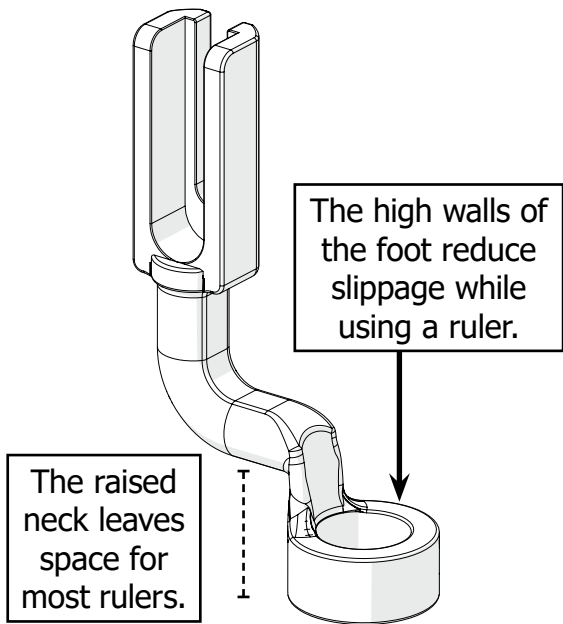

SMP-04-11709

Included Parts & Tools (continued)

SHCS M3 x 8 mm (Hopping Foot Screw)

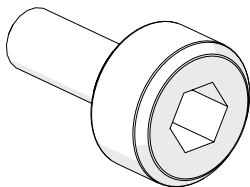

HDW-03-10966

Hopping Foot Height Tool

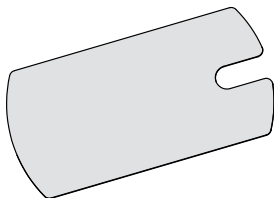

SMP-04-12171

Switching the Accessory Feet

Parts & Tools Needed:

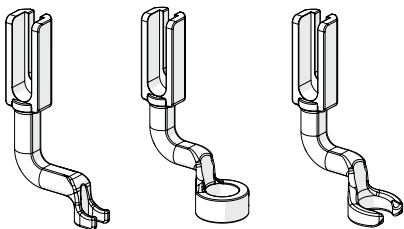

Accessory Hopping Foot

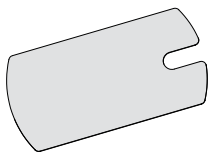

Hopping Foot
Height Tool

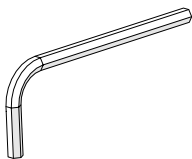

Allen Wrench 3 mm
(not included)

Switching the Feet (continued)

Instructions

Take the following steps to swap out your hopping foot:

- 1 Unscrew the **hopping foot** from the machine with a 3 mm Allen wrench.

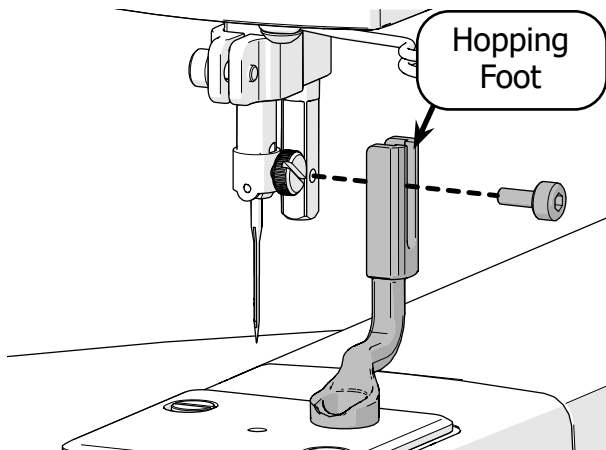

Your machine may not look exactly like the one in the images. However, the installation steps are still the same.

Switching the Feet (continued)

- 2 Loosely attach the **accessory hopping foot** to the machine.

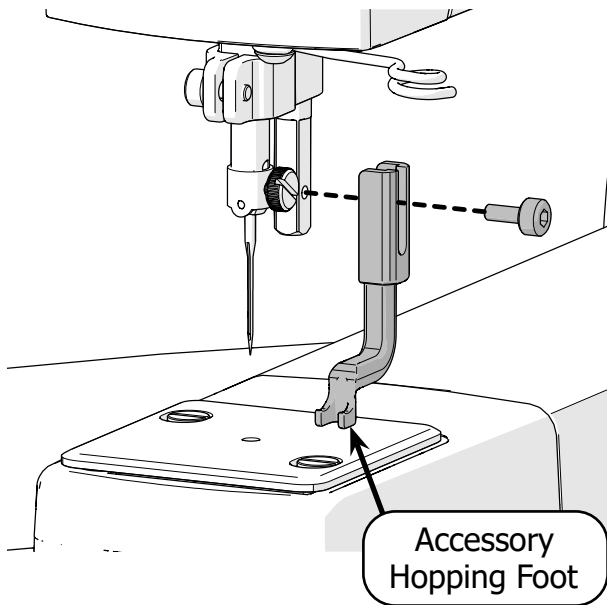

Switching the Feet (continued)

Important: The hopping foot should be loose enough that the hopping foot can slide freely up and down on the bar.

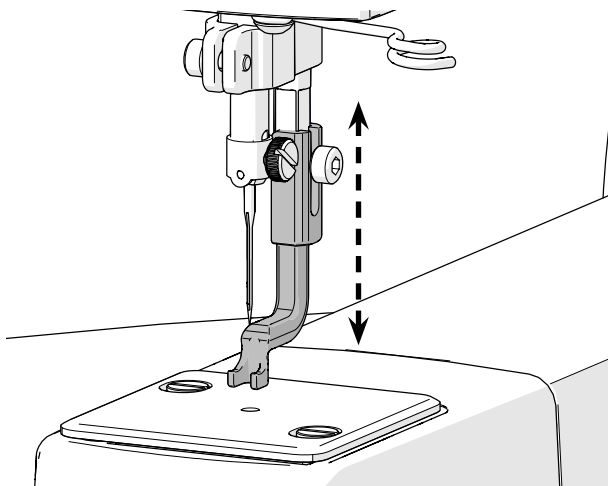

Switching the Feet (continued)

- 3 Move the machine away from fabric to expose the needle plate. Use the machine hand wheel to drop the needle to the lowest position. If you feel resistance, loosen the **hopping foot screw** more.

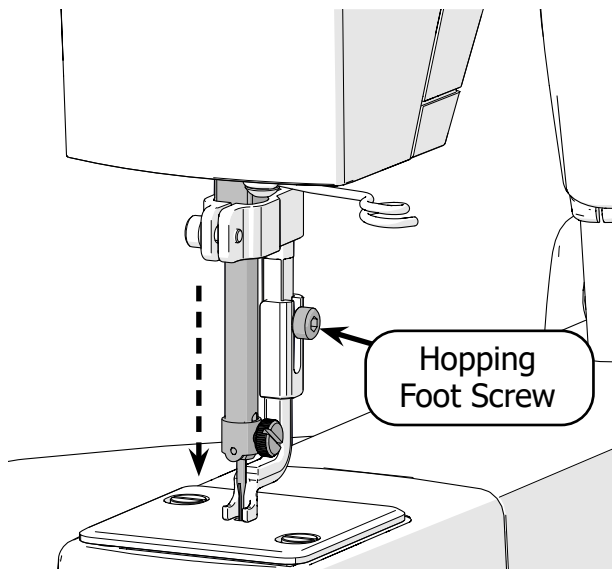

Switching the Feet (continued)

- 4 Slide the **hopping foot height tool** (shown in gray) underneath the hopping foot.

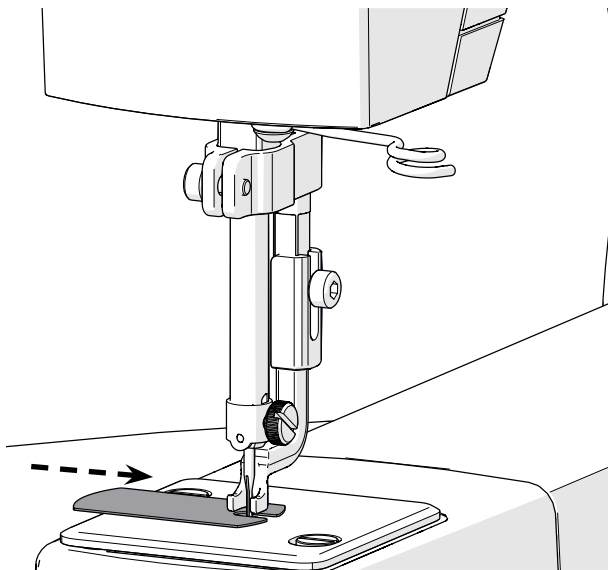

Switching the Feet (continued)

- 5 Tighten the hopping foot screw with a 3 mm Allen wrench.

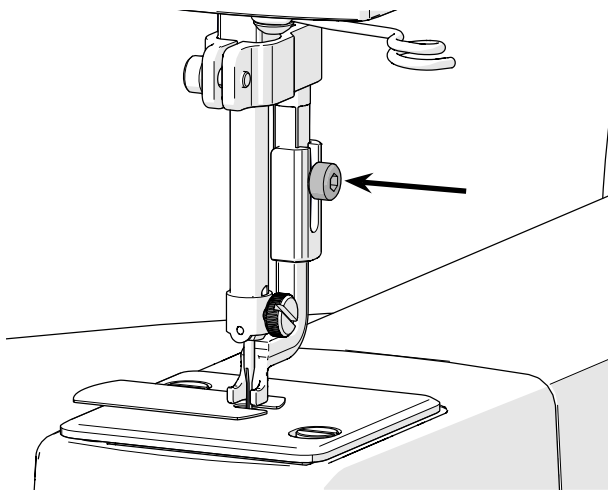

Important: Always set the hopping foot height (as shown in steps 3-5) when you swap out the foot.

Grace
COMPANY

www.graceframe.com

1-800-264-0644